

## Mansfield, Nottinghamshire, NG18 4ZF

Offers Over £140,000

🛏️ 1 🚿 1 🚻 1



- NEWLY BUILT
- AVAILABLE WITH VACANT POSSESSION OR TENANTED
- PRIVATE GARDEN
- GREAT INVESTMENT CURRENTLY YIELDING 6%- LOW MAINTENANCE
- MODERN FITTED KITCHEN AND BATHROOM
- OPEN PLAN LIVING
- ALLOCATED PARKING
- POPULAR LOCATION- JUST OFF SOUTHWELL ROAD WEST
- MEZZANINE STYLE BEDROOM AREA WITH STORAGE
- PLEASE QUOTE REF ML0555 WHEN ENQUIRING

### Ground Floor

Approx. 30.9 sq. metres (332.9 sq. feet)

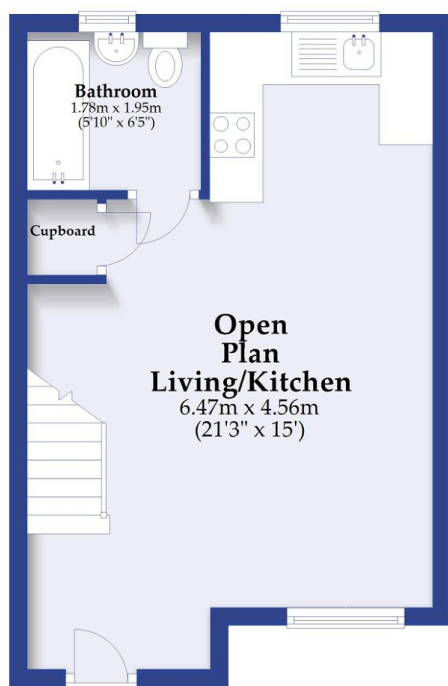

### First Floor

Approx. 19.9 sq. metres (213.9 sq. feet)

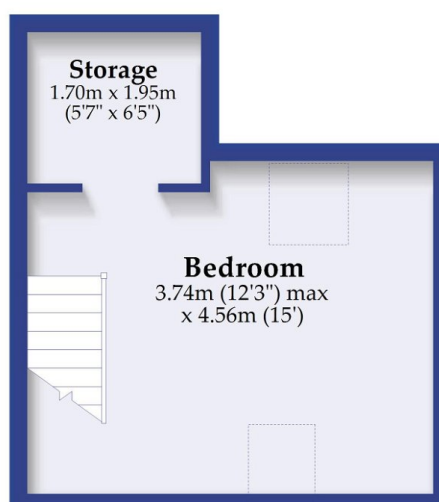

Total area: approx. 50.8 sq. metres (546.8 sq. feet)

A fantastic opportunity to purchase this almost new, immaculate maisonette in a secluded cul-de-sac, just off Southwell Road West in Mansfield. The property would make a perfect first home or an ideal investment, with a tenant currently in situ providing a yield of 6%. Vacant possession is also offered.