

Northcliffe Road, Grantham, Lincolnshire, NG31 8DP

Guide Price £240,000

3 2 2



- Guide Price £240,000 – £250,000 Please Quote reference RS0119.
- Spacious & Versatile Accommodation
- Kitchen/diner, Recently Fitted Family Bathroom & 3 bedrooms
- Located Within Walking Distance Of Excellent Schooling
- Gardens & Good Decorative Finish Throughout.
- A Superb Extended Semi Detached Home
- Ground Floor Wet Room, Lounge/diner, Double Glazed Conservatory With Feature Double Glazed Gable
- Home Office, Gym, & Garage Storage Area
- Gas Heating To Radiators, Double Glazing & uPVC Soffits/Facias,
- Internal Viewing Required To Fully Appreciate.

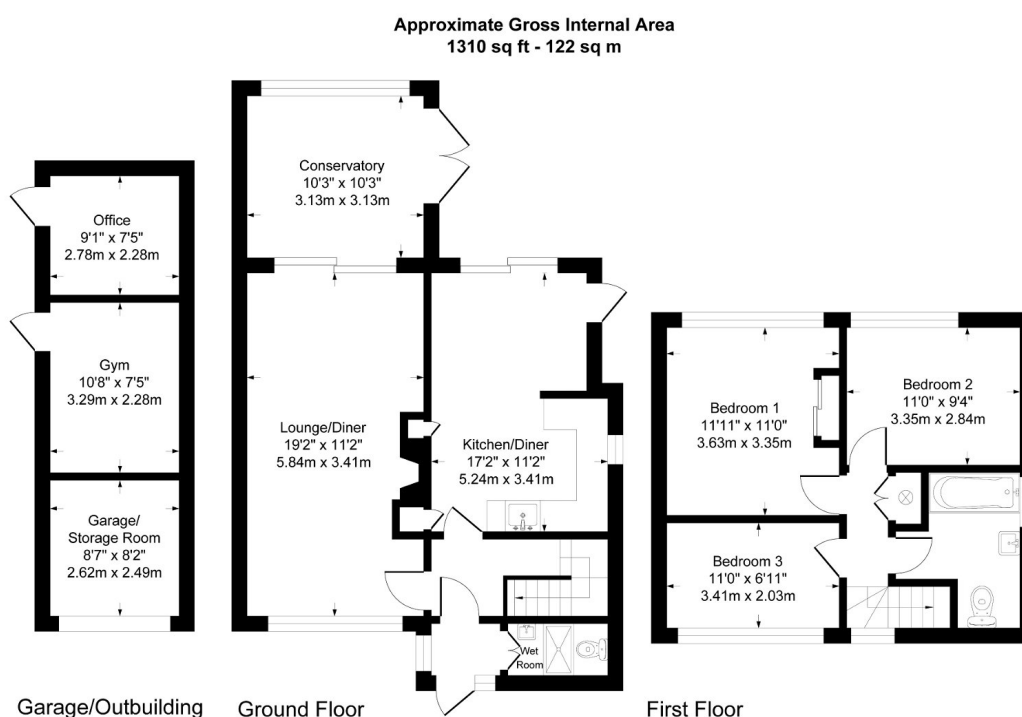

Although every attempt has been made to ensure accuracy, all measurements are approximate.
This floorplan is for illustrative purposes only and not to scale.
Measured in accordance with RICS Standards.

Guide Price £240,000 – £250,000 Please Quote reference RS0119. This superb extended three bedroom residence offers spacious and versatile accommodation, perfect for the modern family. Located within walking distance of excellent schooling facilities, this impressive home requires an internal viewing to fully appreciate.

The accommodation includes an enclosed entrance porch, ground floor wet room, inner hallway, lounge/diner, double glazed conservatory with feature double glazed gable and roofing, kitchen/diner, first floor landing, recently fitted three piece family bathroom, three bedrooms.

The property benefits from a sympathetically converted and extended garage area, which has been seamlessly configured to offer an office, gym, and garage storage area.

Other features of this home include gas heating to radiators, double glazing, uPVC soffits/facias, and high decorative finish throughout.