



£330,000 Leasehold

Featherstone Court, Featherstone Road, Southall, UB2

GROUND FLOOR APARTMENT! Simple Estate Agents present to the market this two bedroom modern apartment located in this popular development. The property benefits from telephone entry system, allocated gated parking, access to communal roof top gardens, two bathroom/shower rooms, private patio and open plan lounge/kitchen. The property is located a short walk to the station, shops, bus stops and local schools. This would be a great first time home or great investment..

Featherstone Court, Featherstone Road, Southall, UB2

Featherstone Court, Featherstone Road, Southall, UB2

Approximate Area = 669 sq ft / 62.2 sq m
For identification only - Not to scale

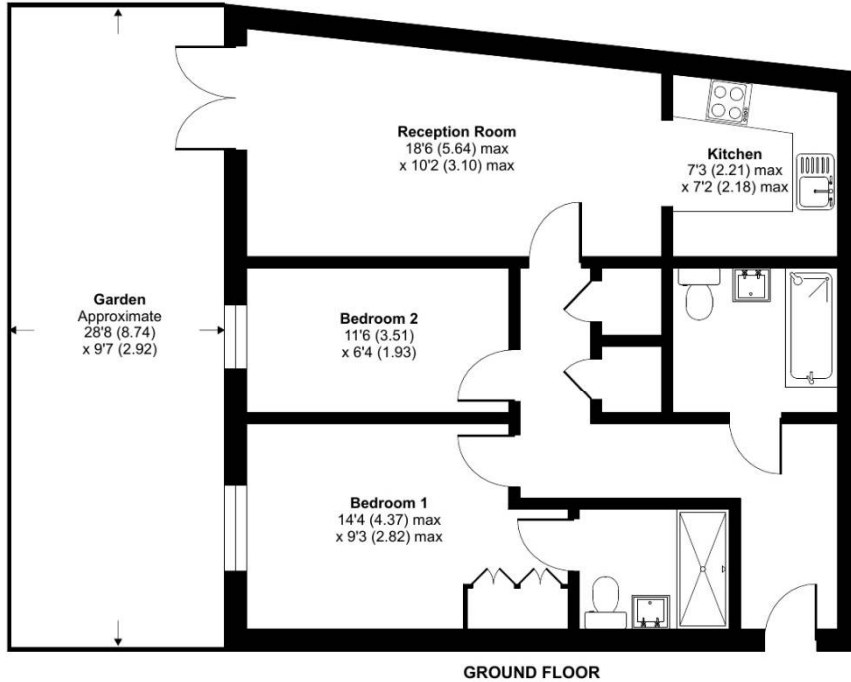

RICS Certified Property Measurer Floor plan produced in accordance with RICS Property Measurement Standards incorporating International Property Measurement Standards (IPMS2 Residential). © nchecon 2024. Produced for Simple Estate Agents. REF: 1130334

Energy Efficiency Rating		
	Current	Potential
Very energy efficient - lower running costs		
(92-100) A		
(81-91) B		
(69-80) C	70	71
(55-68) D		
(39-54) E		
(21-38) F		
(1-20) G		
Not energy efficient - higher running costs		
England, Scotland & Wales	EU Directive 2002/91/EC	

Directions

UB3 3ES Coldharbour Ln, Hayes ? Continue to Coldharbour Ln 25 sec (266 ft) ? Take Pump Ln, The Pkwy/A312, Hayes Rd and Western Rd to Featherstone Rd in Southall 10 min (2.5 mi) At the roundabout, take the 1st exit onto Featherstone Rd Destination will be on the left ? 27 sec (492 ft) UB2 5GQ Featherstone Rd, Southall

Environmental Impact (CO ₂) Rating		
	Current	Potential
Very environmentally friendly - lower CO ₂ emissions		
(92-100) A		
(81-91) B		
(69-80) C	70	71
(55-68) D		
(39-54) E		
(21-38) F		
(1-20) G		
Not environmentally friendly - higher CO ₂ emissions		
England, Scotland & Wales	EU Directive 2002/91/EC	

General: While we endeavour to make our sales particulars fair, accurate and reliable, they are only a general guide to the property and, accordingly, if there is any point which is of particular importance to you, please contact the office and we will be pleased to check the position for you, especially if you are contemplating travelling some distance to view the property. Measurements: These approximate room sizes are only intended as general guidance. You must verify the dimensions carefully before ordering carpets or any built-in furniture. Services: Please note we have not tested the services or any of the equipment or appliances in this property, accordingly we strongly advise prospective buyers to commission their own survey or service reports before finalizing their offer to purchase. THESE PARTICULARS ARE ISSUED IN GOOD FAITH BUT DO NOT CONSTITUTE REPRESENTATIONS OF FACT OR FORM PART OF ANY OFFER OR CONTRACT. THE MATTERS REFERRED TO IN THESE PARTICULARS SHOULD BE INDEPENDENTLY VERIFIED BY PROSPECTIVE BUYERS OR TENANTS. NEITHER SIMPLE ESTATE AGENTS NOR ANY OF ITS EMPLOYEES OR AGENTS HAS ANY AUTHORITY TO MAKE OR GIVE ANY REPRESENTATION OR WARRANTY WHATSOEVER IN RELATION TO THIS PROPERTY.