



**£355,000**  
**6 Hillary Close**  
PO16 7PH

## PROPERTY SUMMARY

NO FORWARD CHAIN. This three bedroom detached bungalow is located in the quiet and rarely available cul de sac of Hillary Close, Fareham. The accommodation consists of three good size bedrooms, a bathroom, a lounge and a kitchen. Other benefits include ample off road parking and a garage. A viewing is highly recommended to fully appreciate everything this property has to offer, to arrange your viewing contact our Fareham office today.





## FRONT

## HALLWAY

**BEDROOM ONE** 11' 09" x 11' 09" (3.58m x 3.58m)

**BEDROOM TWO** 11' 10 max" x 9' 02 max" (3.61m x 2.79m)

**BEDROOM THREE** 11' 08 max" x 8' 00" (3.56m x 2.44m)

**LOUNGE** 14' 02" x 11' 11" (4.32m x 3.63m)

## BATHROOM

**KITCHEN** 12' 02" x 8' 11" (3.71m x 2.72m)

## GARAGE

## REAR GARDEN



GROUND FLOOR

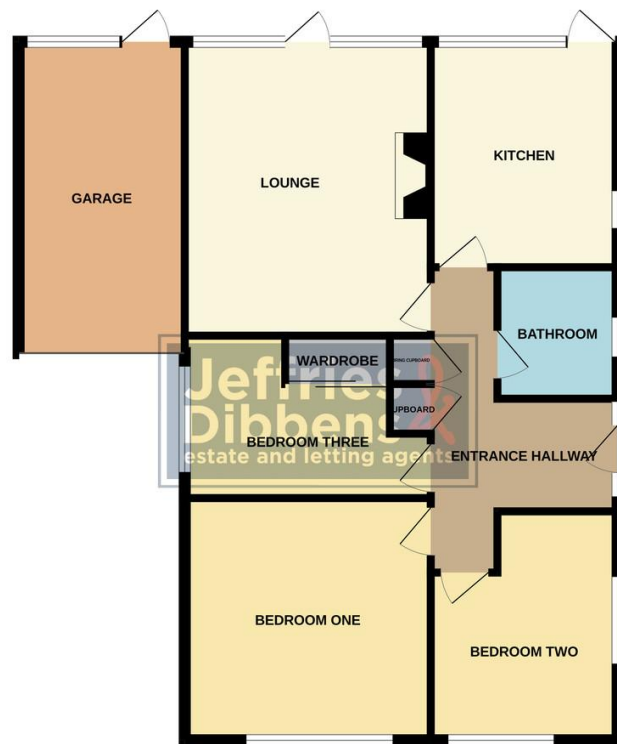

Whilst every attempt has been made to ensure the accuracy of the floorplan contained here, measurements of doors, windows, rooms and any other items are approximate and no responsibility is taken for any error, omission or mis-statement. This plan is for illustrative purposes only and should be used as such by any prospective purchaser. The services, systems and appliances shown have not been tested and no guarantee as to their operability or efficiency can be given.  
Made with Melegix ©2023

**LOCAL AUTHORITY**  
Fareham Borough Council

**TENURE**  
Freehold

**COUNCIL TAX BAND**  
Band D

**VIEWINGS**  
By prior appointment only

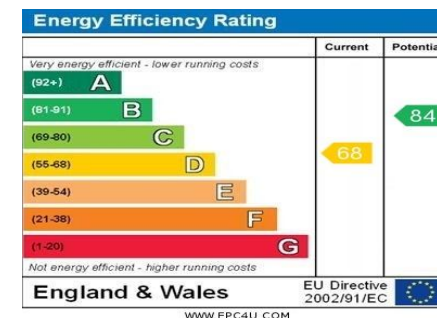

Agents Note: Whilst every care has been taken to prepare these particulars, they are for guidance purposes only. All measurements are approximate and are for general guidance purposes only and whilst every care has been taken to ensure their accuracy, they should not be relied upon and potential buyers/tenants are advised to recheck the measurements



**OFFICE ADDRESS**  
6 West Quay House, 20 West Street, Fareham, Hampshire, PO16 0LG

**CONTACT**  
01329 888 328  
fareham@dibbensproperty.co.uk  
www.jdea.co.uk