



59 Park Road , Hayling Island, PO11 0HT Guide price £600,000

Nestled on Park Road in the charming and desirable West Town of Hayling Island, this exquisite new build, detached home offers a perfect blend of modern living and coastal convenience. Just 500 meters from the pristine Blue Flag beaches and the renowned Hayling Island Golf Club, this property is ideally situated for those who appreciate both leisure and lifestyle.

The home boasts two spacious double bedrooms, each featuring an ensuite shower room that is enhanced by a skylight, allowing for an abundance of natural light while ensuring privacy. A walk-in wardrobe on the landing provides additional storage space.

The open-plan layout on the ground floor is designed for contemporary living, with bifold doors that seamlessly connect the indoor space to the outdoor area. Step outside to discover a beautifully designed garden, which includes a part-paved porcelain patio and a lush lawn, perfect for entertaining or simply enjoying the tranquil surroundings. The extra high boundary wall offers a sense of seclusion, making it feel like a private retreat.

For added convenience, the property includes off-road parking for two vehicles, an electric vehicle charger, and easy street parking for guests. Solid oak doors throughout the home add a touch of elegance, while solar panels on the roof contribute to energy efficiency.

This property is not just a home; it is a lifestyle choice in a sought-after location, with local amenities in West Town just a short walk away. Whether you are looking for a permanent residence or a holiday retreat, this modern home on Hayling Island is sure to impress.

- New Build, Detached Home
- Two Double Bedrooms - Ensuite Shower Room To Both With Skylights
- EV Charger and Off Road Parking For Two Vehicles, Plus Easy Street Parking
- Situated A Mere 500 Meters From The Blue Flag Beaches, Hayling Island Golf Club and a short walk to the local amenities, in West Town
- Open Plan Layout with Bifolds Leading To ; Porcelain Patio (with hidden eco drainage) and Lush Lawns - An Extra High Boundary Wall Provides Extra Privacy,
- Downstairs W.C and Utility Space
- Beautiful Entrance Hall With Full Height Windows - Under Stair Storage
- Available Now - Chain Free - Viewings Highly Recommended
- Hayling Island ; promises a wonderful place to live for all ages or a fantastic place to holiday!
- Sought After Location; Without Doubt One of the Most Highly-Desirable Roads on the Island

Viewing

Please contact our ROK Marsh Office on 02393233267 if you wish to arrange a viewing appointment for this property or require further information.

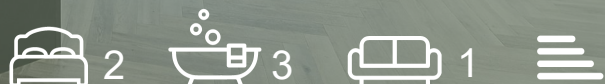

Floor Plan

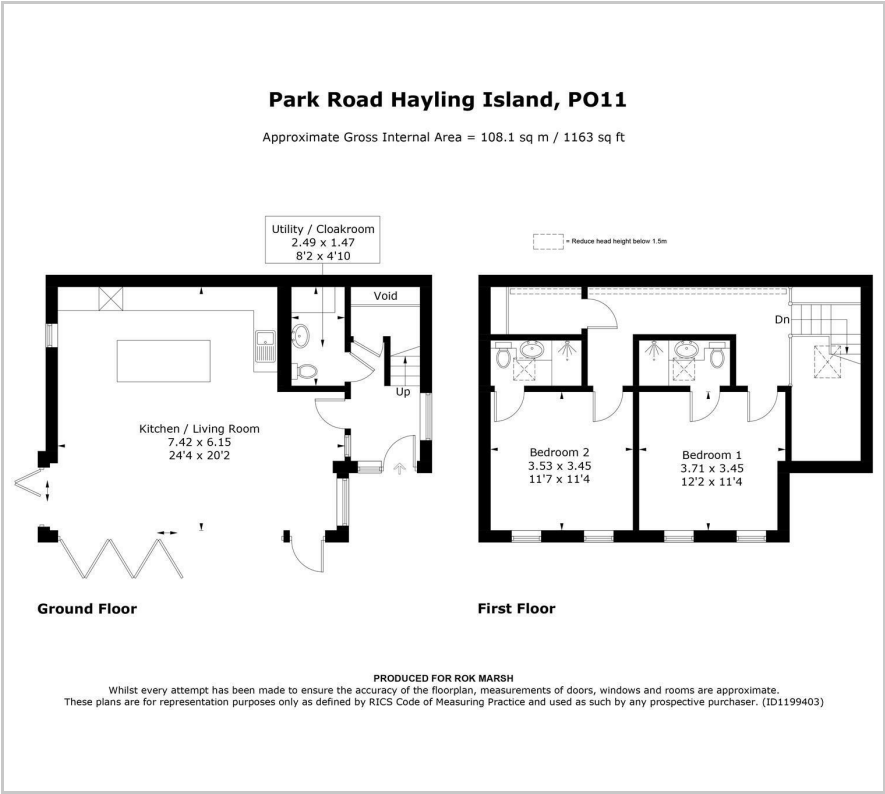

Area Map



Energy Efficiency Graph

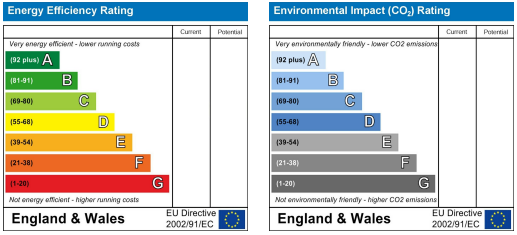

These particulars, whilst believed to be accurate are set out as a general outline only for guidance and do not constitute any part of an offer or contract. Intending purchasers should not rely on them as statements of representation of fact, but must satisfy themselves by inspection or otherwise as to their accuracy. No person in this firms employment has the authority to make or give any representation or warranty in respect of the property.