



16 Willow Tree Avenue

, Waterlooville, PO8 8AN

Offers in excess of £450,000

Nestled on the charming Willow Tree Avenue in Waterlooville, this stunning, Chain Free, three bedroom, semi-detached house with ample parking has undergone a complete transformation, making it a turn-key home ready for you to move in to !

- Three Double Bedrooms, Semi Detached
- Ample Off Road Parking
- Renovated Front to Back and Top to Bottom
- Attic Conversion and Rear Extensions
- Summer House with Electric and Hot Tub Plumbing
- Beautiful 'Turn Key'. Pick Your Bags Up And Move Straight In Property
- CHAIN FREE
- Very Desirable Location
- Downstairs W.C, Upstairs Family Bathroom and Ensuite Shower Room to Master
- VIEWINGS HIGHLY RECOMMENDED !

Viewing

Please contact our ROK Marsh Office on 02393233267 if you wish to arrange a viewing appointment for this property or require further information.



3



2



2



D

Floor Plan

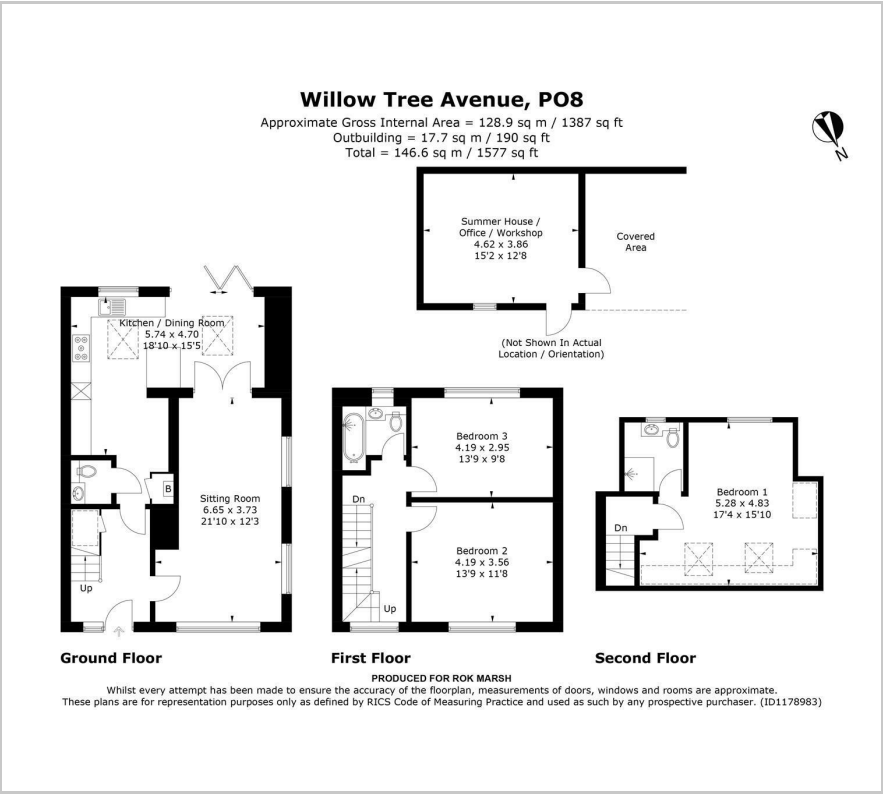

Area Map



Energy Efficiency Graph

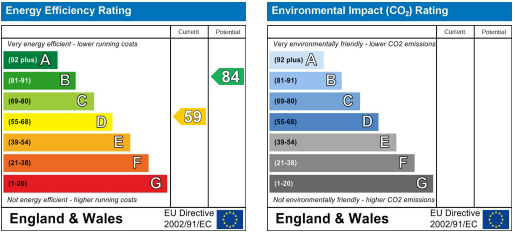

These particulars, whilst believed to be accurate are set out as a general outline only for guidance and do not constitute any part of an offer or contract. Intending purchasers should not rely on them as statements of representation of fact, but must satisfy themselves by inspection or otherwise as to their accuracy. No person in this firms employment has the authority to make or give any representation or warranty in respect of the property.