



**58 Kirpal Road**

, Portsmouth, PO3 6FD

**Guide price £315,000**

Unexpectedly Re-available Again Due to Chain Collapse  
| Three Bedrooms | Off Road Parking for several vehicles |  
| Downstairs W.C | Conservatory | EPC Rating C | Modern  
Fitted Kitchen | Mid Terrace | Well Presented | Next to  
Tamworth Park - great for dog walks and playing for children |  
Secure and Private Cul De Sac Location

Viewing

Please contact our ROK Marsh Office on 02393233267  
if you wish to arrange a viewing appointment for this property or  
require further information.



3



2



1

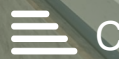

C



Floor Plan

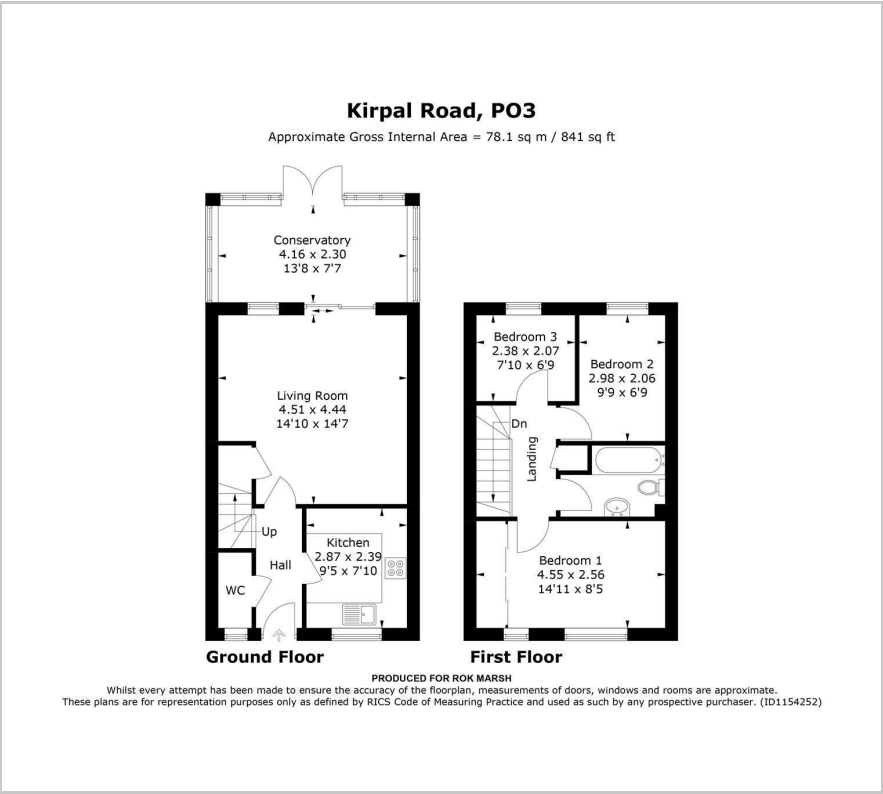

Area Map



Energy Efficiency Graph

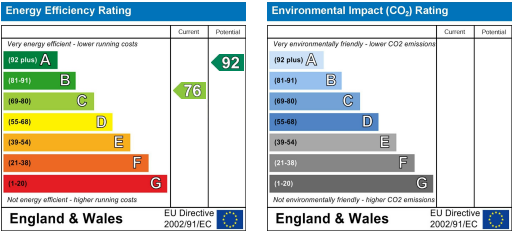

These particulars, whilst believed to be accurate are set out as a general outline only for guidance and do not constitute any part of an offer or contract. Intending purchasers should not rely on them as statements of representation of fact, but must satisfy themselves by inspection or otherwise as to their accuracy. No person in this firms employment has the authority to make or give any representation or warranty in respect of the property.