



21 Carnarvon Road

, Portsmouth, PO2 7NJ

Offers in excess of £210,000

Unexpectedly re-available due to a change in circumstance with the buyer - **THREE BEDROOMS | MID TERRACED | TWO RECEPTION ROOMS | WEST FACING GARDEN | IDEAL FIRST TIME PURCHASE OR INVESTMENT | SMALL, COMPLETE ONWARD CHAIN | CENTRAL HEATING AND DOUBLE GLAZED WINDOWS | CLOSE TO LOCAL SCHOOLS, SHOPS AND TRANSPORT LINKS | NEW BANNISTERS AND INTERNAL DOORS**

- THREE BEDROOMS
- MID TERRACED
- TWO RECEPTION ROOMS
- WEST FACING GARDEN
- IDEAL FIRST TIME PURCHASE TO PUT YOUR OWN STAMP ON
- IDEAL INVESTMENT OR FLIP PROJECT
- SMALL, COMPLETE ONWARD CHAIN
- CLOSE TO LOCAL SCHOOLS, SHOPS AND TRANSPORT LINKS
- CENTRAL HEATING AND DOUBLE GLAZED WINDOWS
- NEW BANNISTERS AND INTERNAL DOORS

Viewing

Please contact our ROK Marsh Office on 02393233267 if you wish to arrange a viewing appointment for this property or require further information.



Floor Plan

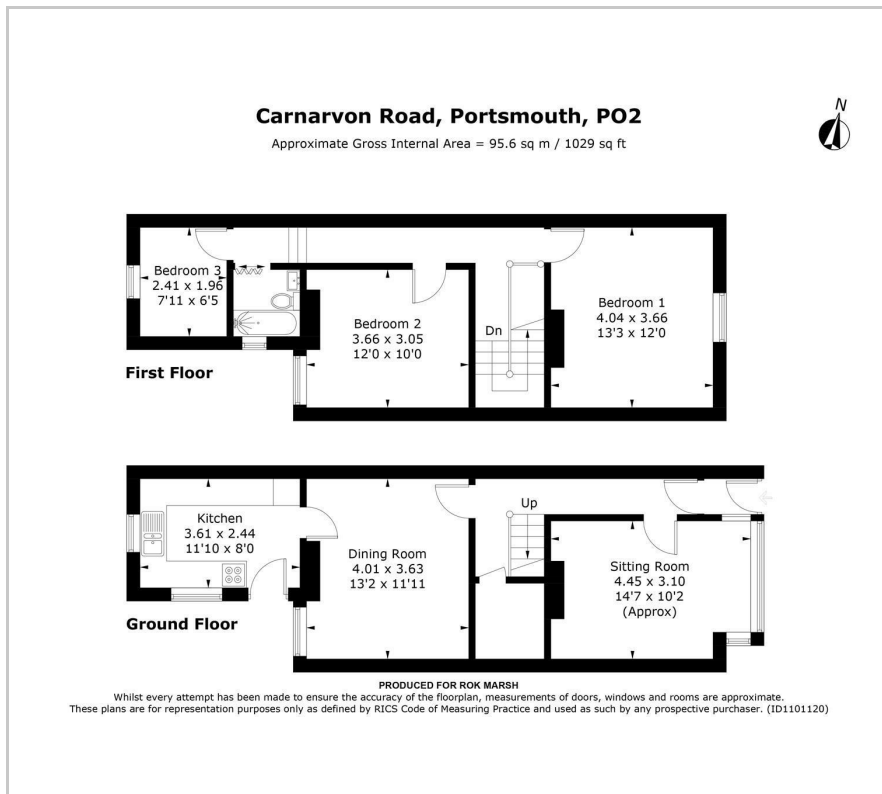

Area Map

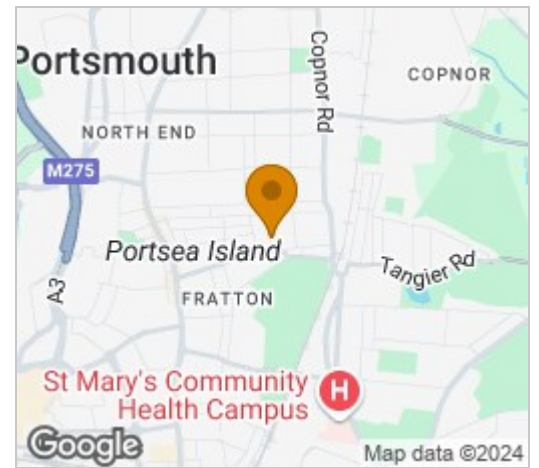

Energy Efficiency Graph

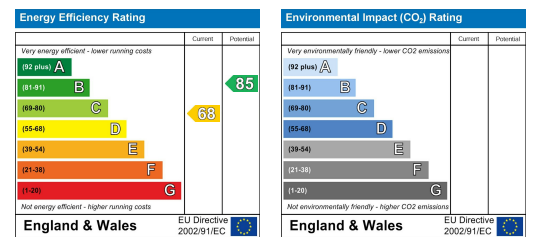

These particulars, whilst believed to be accurate are set out as a general outline only for guidance and do not constitute any part of an offer or contract. Intending purchasers should not rely on them as statements of representation of fact, but must satisfy themselves by inspection or otherwise as to their accuracy. No person in this firm's employment has the authority to make or give any representation or warranty in respect of the property.