



22 Rowlands Avenue

, Waterloooville, PO7 7RU

Asking price £400,000

Welcome to Rowlands Avenue, Waterloooville - a charming property that offers the perfect blend of character and modern living. This delightful chalet bungalow, boasts 4 bedrooms and 2 reception rooms spread across a generous 1,988 sq ft of living space.

Situated in a prime location, this property provides the convenience of being close to local shops while still offering a tranquil residential setting. The off-road parking for at least 2 vehicles as well as a garage with light & power ensures that parking will never be an issue for you or your guests.

With no forward chain, the process of making this property your new home is made even smoother. The spacious layout of this pre-war bungalow allows for comfortable living and the potential to create your dream space.

Don't miss out on the opportunity to own this beautiful property in Waterloooville. Contact us today to arrange a viewing and take the first step towards making this charming bungalow your new home.

- NO FORWARD CHAIN
- Four Double Bedroom Chalet Bungalow
- Off Road Parking & Garage
- Private Garden
- Modern Kitchen & Utility Space
- Upstairs Bathroom & Downstairs W.C.
- Close to Local Shops, Schools & Amenities
- Easy onto the A3(M)
- Gas Central Heating
- Double Glazed

Viewing

Please contact our ROK Marsh Office on 02393233267 if you wish to arrange a viewing appointment for this property or require further information.



4



2



2



D

Floor Plan

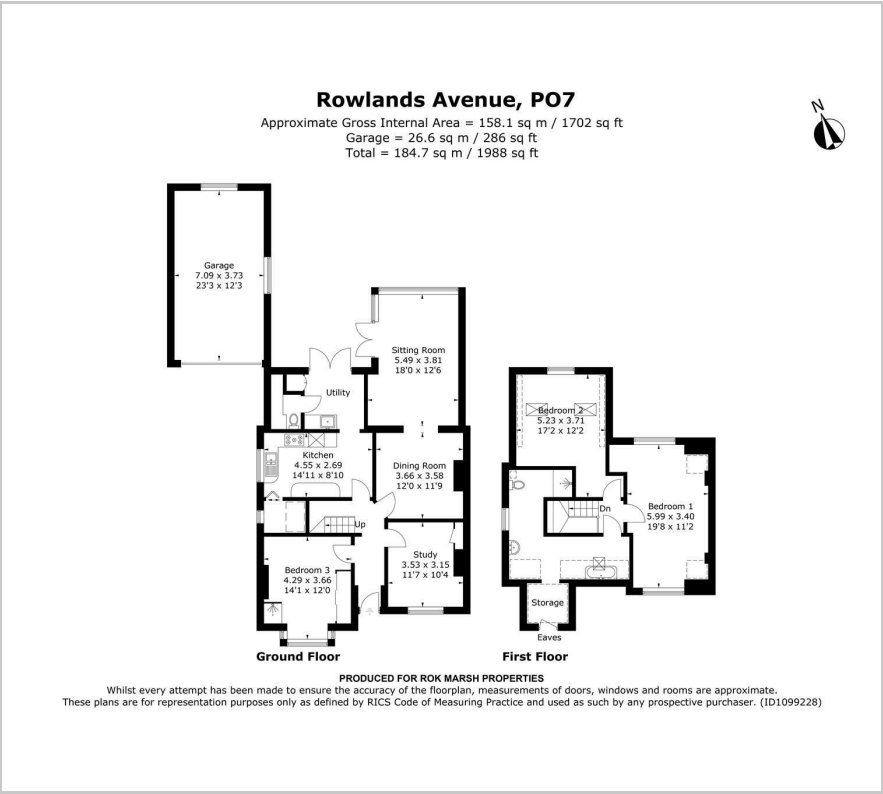

Area Map



Energy Efficiency Graph

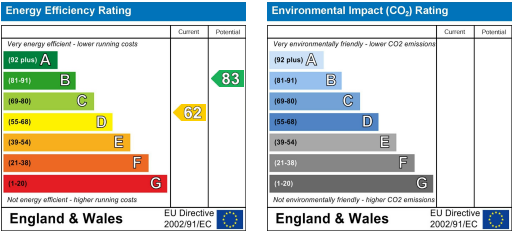

These particulars, whilst believed to be accurate are set out as a general outline only for guidance and do not constitute any part of an offer or contract. Intending purchasers should not rely on them as statements of representation of fact, but must satisfy themselves by inspection or otherwise as to their accuracy. No person in this firms employment has the authority to make or give any representation or warranty in respect of the property.