



Flat 13, 36, Norman Court Craneswater Park

, Southsea, PO4 0LY

Guide price £250,000

GREAT LOCATION! We are delighted to present to you this wonderful apartment situated in the popular Craneswater Park. Well presented throughout, the property boasts two double bedrooms, a modern kitchen, a large lounge/dining room and a garage.

- Two Double Bedrooms
- Garage
- Sought After Location
- Well Presented Throughout
- Close to Local Amenities
- Long Lease & No Ground Rent
- Lift
- Visitor Parking

Please contact our ROK Marsh Office on 02393233267 if you wish to arrange a viewing appointment for this property or require further information.



Floor Plan

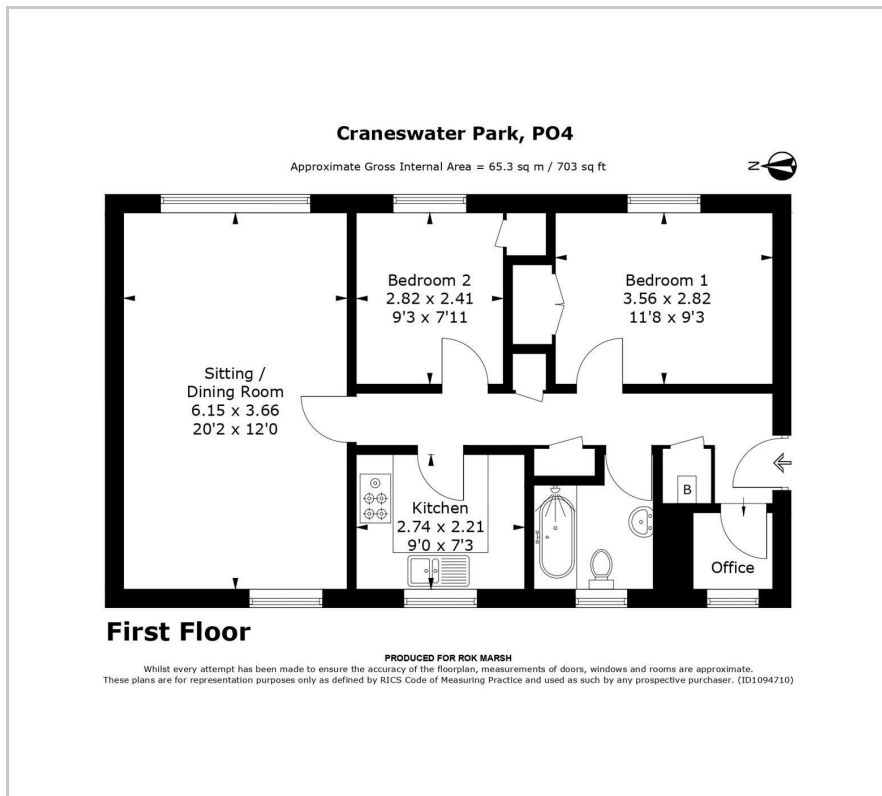

Area Map



Energy Efficiency Graph

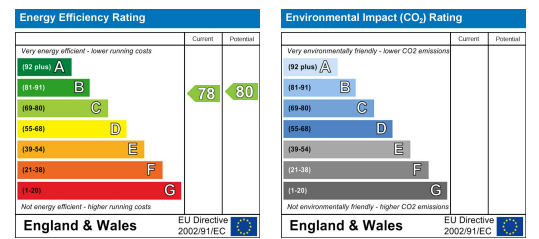

These particulars, whilst believed to be accurate are set out as a general outline only for guidance and do not constitute any part of an offer or contract. Intending purchasers should not rely on them as statements of representation of fact, but must satisfy themselves by inspection or otherwise as to their accuracy. No person in this firm's employment has the authority to make or give any representation or warranty in respect of the property.