



6 Bosham Gardens

, Emsworth, PO10 7FH

Offers in excess of £325,000

We are delighted to bring to market this his delightful mid-terrace house nestled in the charming Bosham Gardens of Emsworth. Boasting two bedrooms, two bathrooms and a large family reception room. Well presented throughout, this property is perfect for first time buyers.

- Two Bedroom House
- Off Road Parking
- Great EPC Rating
- Desired Location
- Well Presented Throughout
- Close To Local Amenities

View

Please contact our ROK Marsh Office on 02393233267 if you wish to arrange a viewing appointment for this property or require further information.



2



2



1



B

Floor Plan

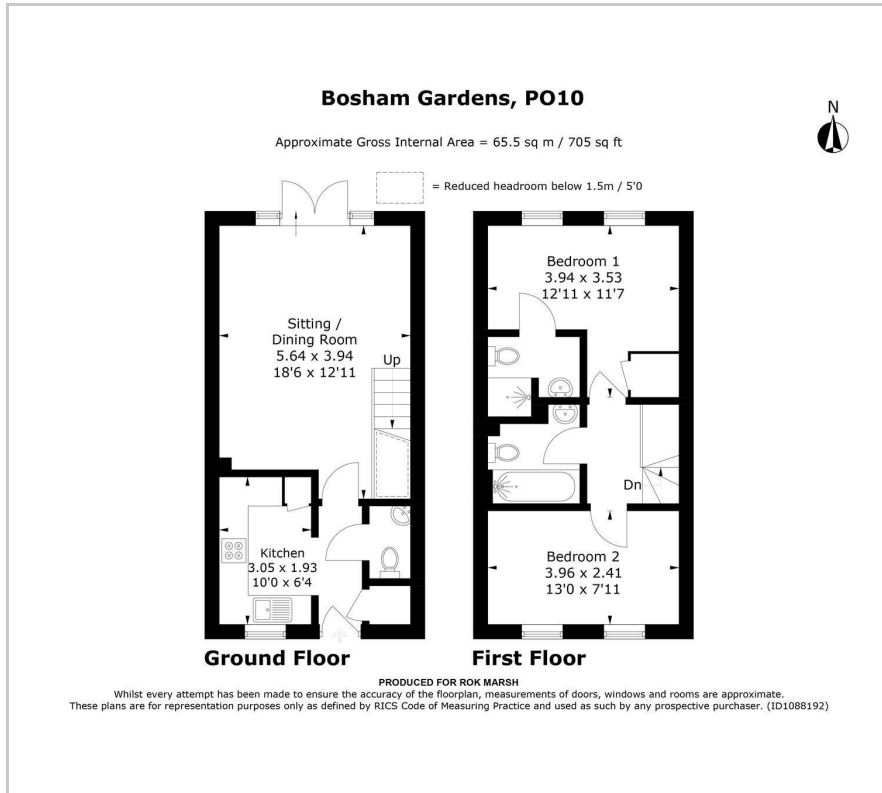

Area Map



Energy Efficiency Graph

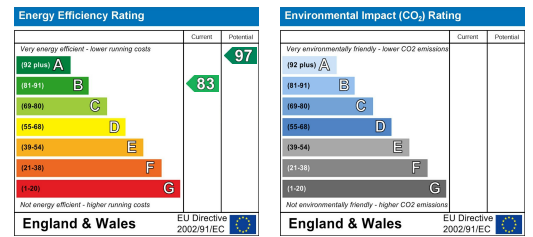

These particulars, whilst believed to be accurate are set out as a general outline only for guidance and do not constitute any part of an offer or contract. Intending purchasers should not rely on them as statements of representation of fact, but must satisfy themselves by inspection or otherwise as to their accuracy. No person in this firm's employment has the authority to make or give any representation or warranty in respect of the property.