



17 Burwood Grove

, Hayling Island, PO11 9DS

Offers in excess of £425,000

Guide Price is £425,000 - £450,000

We are delighted to present to you this Four Bedroom Detached Home which is available now with NO FORWARD CHAIN. Located in a sought after residential area in Hayling Island, the property benefits from being well presented throughout, featuring a large open plan kitchen / diner, ample living and bedroom space, a driveway and a garage. We highly recommend a viewing to appreciate this wonderful property.

- Detached Home
- No Forward Chain
- Quiet Cul De Sac
- Four Bedrooms
- Driveway
- Utility Room
- Spacious Kitchen / Dining Room
- Well Presented Throughout

Viewing

Please contact our ROK Marsh Office on 02393233267 if you wish to arrange a viewing appointment for this property or require further information.



Floor Plan

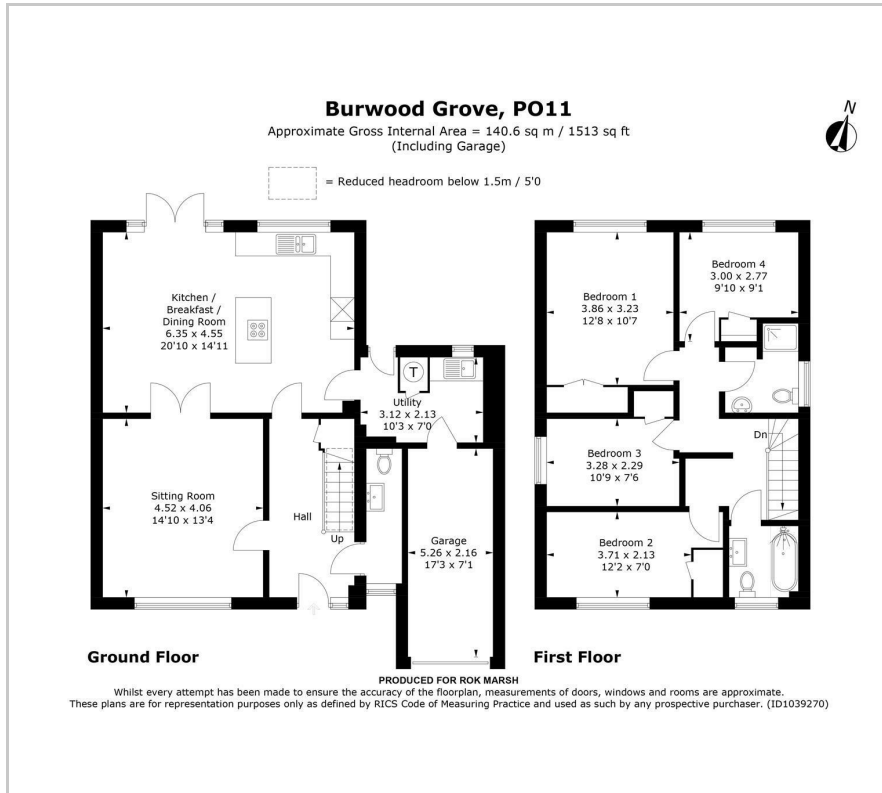

Area Map



Energy Efficiency Graph

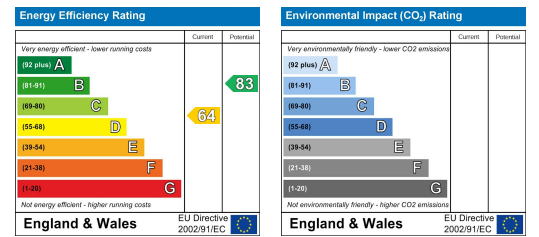

These particulars, whilst believed to be accurate are set out as a general outline only for guidance and do not constitute any part of an offer or contract. Intending purchasers should not rely on them as statements of representation of fact, but must satisfy themselves by inspection or otherwise as to their accuracy. No person in this firm's employment has the authority to make or give any representation or warranty in respect of the property.