

THE
PROPERTY
OUTLET

Bristol's home for Stylish Sales & Lettings



EASTFIELD TERRACE
HENLEAZE





EASTFIELD TERRACE

HENLEAZE, BS9 4BW - £1,250 PCM



2 Bedroom(s)



1 Bathroom(s)



0.00 sq ft

* AVAILABLE 16.08.2025 *

WELL PRESENTED PURPOSE BUILT APARTMENT! The Property Outlet are keen to offer to the rental market this GROUND FLOOR APARTMENT in a WELL MAINTAINED BLOCK. The accommodation comprises COMMUNAL ENTRANCE, HALLWAY, LIVING/DINING ROOM , REFITTED KITCHEN, TWO BEDROOMS & a REFITTED BATH/SHOWER ROOM & W/C. WHITE GOODS include a WASHING MACHINE, ELECTRIC HOB/OVEN & a FRIDGE/FREEZER. Benefits include OFF ROAD PARKING & COMMUNAL GARDENS. Situated in a PERFECT LOCATION FOR HENLEAZE ROAD, BUS ROUTES & LOCAL AMENITIES. Sorry no pets.

Holding Deposit £288.46

COUNCIL TAX BAND - C

- Two Bedroom Apartment
- Unfurnished
- Electric Hob/Oven
- Washing Machine
- Fridge/Freezer
- Suit a Couple
- Suit Professionals
- Close To Henleaze Park
- Close To Local Shops
- Well Presented

PROPERTY SPECIALIST

Mr Carl Mortimore
c.mortimore@thepropertyoutlet.con
01179354565
Branch manager

GROUND FLOOR
485 sq.ft. (45.0 sq.m.) approx.

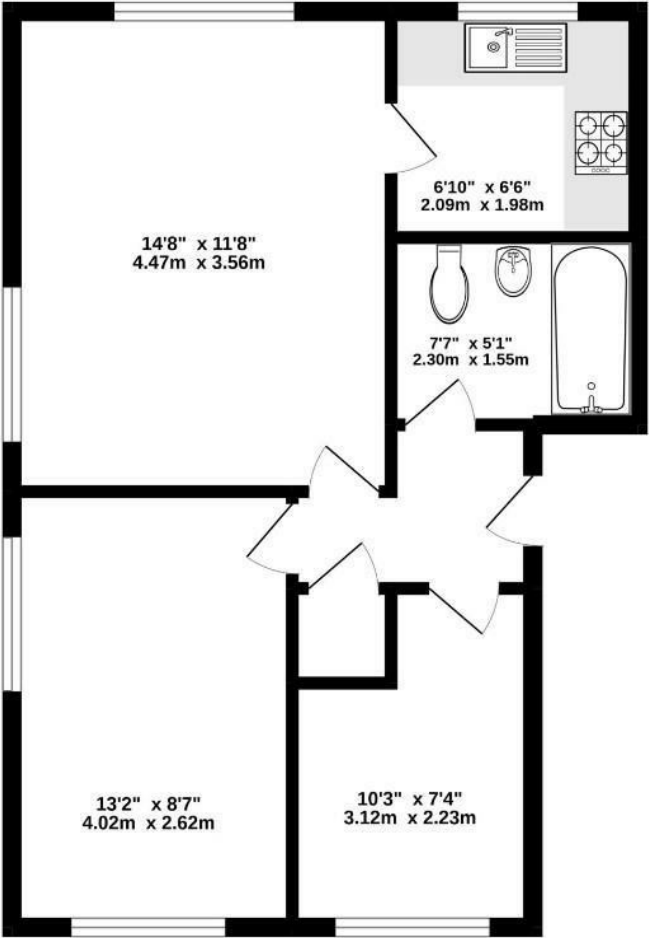

TOTAL FLOOR AREA : 485 sq.ft. (45.0 sq.m.) approx.
Whilst every attempt has been made to ensure the accuracy of the floorplan contained here, measurements of doors, windows, rooms and any other items are approximate and no responsibility is taken for any error, omission or mis-statement. This plan is for illustrative purposes only and should be used as such by any prospective purchaser. The services, systems and appliances shown have not been tested and no guarantee as to their operability or efficiency can be given.
Made with Metropix ©2022

