

THE  
PROPERTY  
OUTLET

*Bristol's home for Stylish Sales & Lettings*



BEVERLEY ROAD  
HORFIELD





COMMUNAL ENTRANCE/HALLWAY  
ENTRANCE  
OPEN PLAN KITCHEN/LIVING ROOM  
3.61 x 3.51 (11'10" x 11'6")  
KITCHEN AREA  
LIVING ROOM  
DOUBLE BEDROOM  
3.17 2.01 (10'4" 6'7")  
RE-FITTED SHOWER ROOM  
1.84 1.76 (6'0" 5'9")  
REAR COMMUNAL GARDEN  
TENURE  
COUNCIL TAX  
SERVICE CHARGES  
GROUND RENT









# BEVERLEY ROAD

HORFIELD, BS7 0JJ - £800 PER MONTH

 1 Bedroom(s)

 1 Bathroom(s)

 290.62 sq ft

\* AVAILABLE NOW \*

SHORT TERM LET ONLY  
FANTASTIC ONE BEDROOM FLAT! The Property Outlet are delighted to offer to the rental market this FIRST FLOOR FLAT that is in the PERFECT LOCATION FOR AIRBUS & SOUTHMEAD HOSPITAL EMPLOYEES. The accommodation comprises, ENTRANCE HALL, ONE DOUBLE BEDROOM, FITTED KITCHEN/LIVING ROOM & a BATH/SHOWER ROOM & WC. Benefits include DOUBLE GLAZING & ELECTRIC HEATING. Outside is a STORAGE FOR BIKES, OFF ROAD PARKING & a COMMUNAL GARDEN to enjoy. This well presented flat would suit a SINGLE PROFESSIONAL PERSON & is NEAR PUBLIC TRANSPORT CONNECTIONS on Gloucester Road & Filton Avenue, where there are also LOCAL AMENITIES & SHOPS. Sorry no pets.

Holding Deposit £184.61

## COUNCIL TAX BAND - A

- SHORT TERM LET ONLY
- Electric Heating
- Unfurnished
- Great Location
- Suit a Single Person
- Double Glazing
- Fridge/Freezer
- Electric Hob/Electric Oven
- Close To Southmead Hospital
- Washing Machine

### PROPERTY SPECIALIST

Mr Carl Mortimore  
c.mortimore@thepropertyoutlet.con  
01179354565  
Branch manager



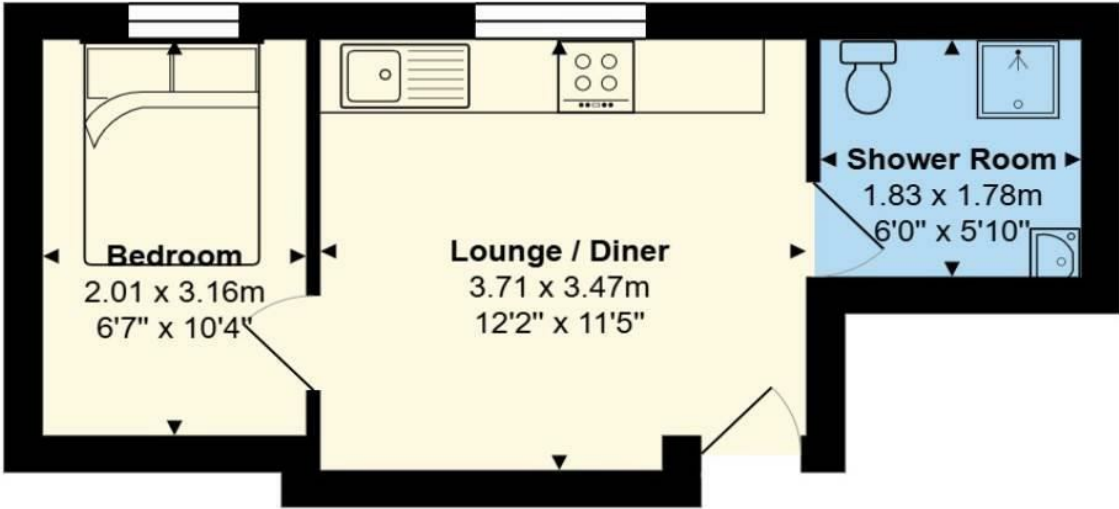

4 Beverley Court, Bristol, BS7 0JJ

All measurements are approximate and for display purposes only

