

THE
PROPERTY
OUTLET

Bristol's home for Stylish Sales & Lettings



BEVERLEY ROAD
HORFIELD



COMMUNAL ENTRANCE/HALLWAY
ENTRANCE
OPEN PLAN KITCHEN/LIVING ROOM
3.61 x 3.51 (11'10" x 11'6")
KITCHEN AREA
LIVING ROOM
DOUBLE BEDROOM
3.17 2.01 (10'4" 6'7")
RE-FITTED SHOWER ROOM
1.84 1.76 (6'0" 5'9")
REAR COMMUNAL GARDEN
TENURE
COUNCIL TAX
SERVICE CHARGES
GROUND RENT





BEVERLEY ROAD

HORFIELD, BS7 0JJ - £875 PER MONTH



1 Bedroom(s)



1 Bathroom(s)



290.62 sq ft

* AVAILABLE NOW *

FANTASTIC ONE BEDROOM FLAT! The Property Outlet are delighted to offer to the rental market this FIRST FLOOR FLAT that is in the PERFECT LOCATION FOR AIRBUS & SOUTHMEAD HOSPITAL EMPLOYEES. The accommodation comprises, ENTRANCE HALL, ONE DOUBLE BEDROOM, FITTED KITCHEN/LIVING ROOM & a BATH/SHOWER ROOM & WC. Benefits include DOUBLE GLAZING & ELECTRIC HEATING. Outside is a STORAGE FOR BIKES, OFF ROAD PARKING & a COMMUNAL GARDEN to enjoy. This well presented flat would suit a COUPLE or a SINGLE PROFESSIONAL PERSON & is NEAR PUBLIC TRANSPORT CONNECTIONS on Gloucester Road & Filton Avenue, where there are also LOCAL AMENITIES & SHOPS. Sorry no pets.

Holding Deposit £201.92



PROPERTY SPECIALIST

Mr Carl Mortimore
c.mortimore@thepropertyoutlet.con
01179354565
Branch manager

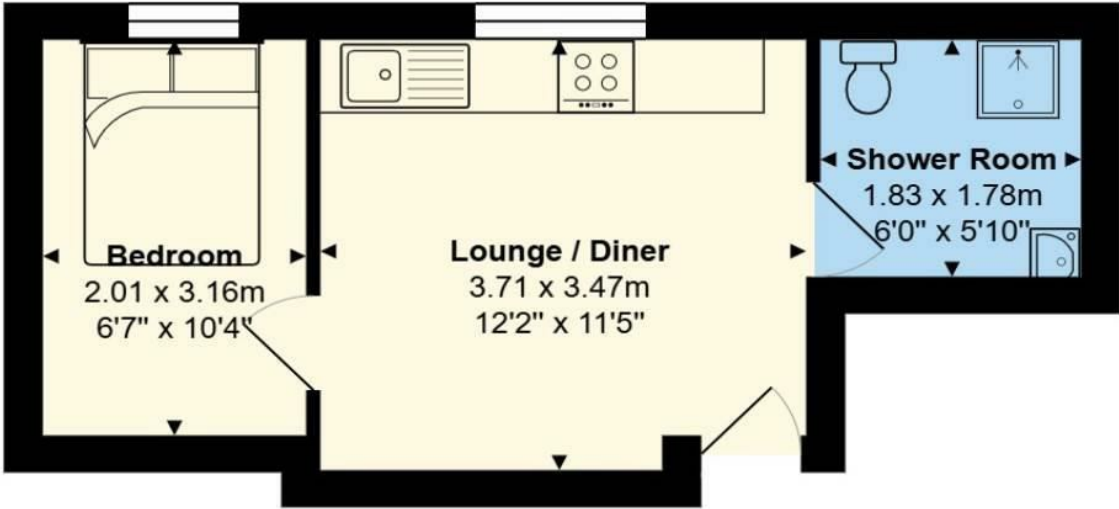

4 Beverley Court, Bristol, BS7 0JJ

All measurements are approximate and for display purposes only

