

69 Fairlee Road Newport, PO30 2EL

£315,000



This stunning 3 bedroom semi-detached house is ideally located on the outskirts of Newport town, within walking distance to the River Medina, local schools and shops. The downstairs consists of two good sized reception rooms, modern fitted kitchen and W/C. Upstairs the property offers 2 double bedrooms, one single bedroom and a family bathroom. Outside the property features off road parking for 2 vehicles at the front. The rear garden has a wooden bar area perfect for the summer and hosting guests, you also have a patio and lawned area. This perfect family home is a must see!!

SEMI DETACHED HOUSE

OFF ROAD PARKING

TWO RECEPTION ROOMS

LOG BURNER

DOUBLE GLAZING & GAS CENTRAL HEATING

CLOSE TO SCHOOLS

ROOMS

Entrance Hallway

Living Room 16' 5" x 13' 10" (5.00m x 4.21m)
A good sized living room with bay window, log burner, double glazing and gas central heating.

Dining Room 13' 8" x 10' 2" (4.16m x 3.10m)
A good sized dining room with double glazed double doors into the garden. Gas central heating.

Kitchen 14' 8" x 8' 2" (4.47m x 2.49m)
A galley style kitchen with space for all modern appliances, double glazed window and double glazed door into the garden.

Downstairs W/C
Tucked under the stairs is a low level W/C and basin.

Bathroom 7' 10" x 8' 3" (2.39m x 2.51m)
A lovely family bathroom with free standing shower, basin, low level W/C, bath and heated towel rail. Opaque double glazed window.

Bedroom 2 13' 8" x 10' 7" (4.16m x 3.22m)
A large second bedroom, which will comfortably fit a king size bed and furniture, double glazed window and gas central heating.

Master bedroom 16' 10" x 12' 2" (5.13m x 3.71m)
A large master bedroom which has a double glazed bay window, feature fireplace and gas central heating.

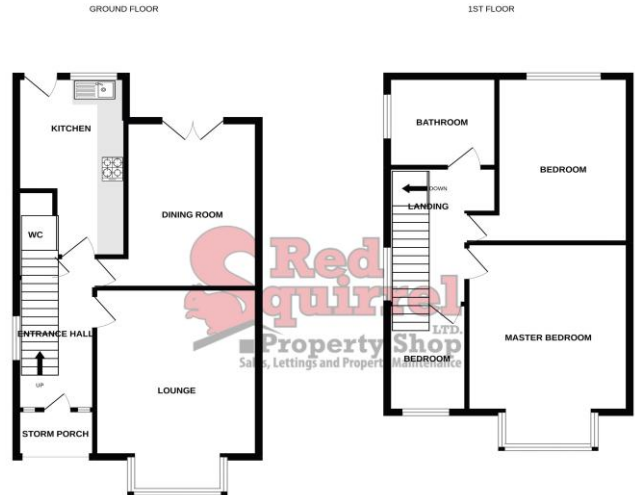

Bedroom 3 8' 10" x 6' 5" (2.69m x 1.95m)
A good sized single bedroom with gas central heating and double glazing.

Outside
The property benefits from off road parking for 3/4 vehicles at the front. At the rear of the property there is a home bar, good sized patio and lawned area.

