

11 Lanes End Totland Bay, PO39 0AL

£220,000



!! CHAIN-FREE!! This two-bedroom terraced house is located in the quiet and tranquil village of Totland. With a well-sized living room and spacious kitchen, the property comes with two double bedrooms and a family bathroom with bath and shower. It also benefits from an easy-to-maintain rear garden with access from the side and rear of the property.

!CHAIN FREE!

ALLOCATED PARKING SPACE

GAS CENTRAL HEATING

CLOSE TO PARKS AND SCHOOLS

WALKING DISTANCE TO THE BEACH

NEWLY DECORATED THROUGHOUT

ROOMS

Hallway

Entrance Hall that has access to the kitchen, leading to the living room, with a storage cupboard underneath the stairs, vinyl floored throughout

Living Room 13' 0" x 12' 8" (3.97m x 3.85m)

Well-sized living room with a double-glazed window to the rear aspect, and vinyl flooring throughout. PVC door to the rear garden of the property. Stairway leading to the 1st floor.

Kitchen 8' 10" x 8' 6" (2.70m x 2.60m)

Double-glazed window to the front aspect of the property overlooking the walkway to the house, wall kitchen units hung on two of the walls. Vinyl Flooring throughout.

Bedroom 1 8' 6" x 12' 8" (2.60m x 3.85m)

Well sized double bedroom to the rear aspect of the property, double glazed window to the rear aspect of the property. Carpet flooring throughout.

Family Bathroom 4' 11" x 9' 5" (1.51m x 2.86m)

Family-sized bathroom with over-the-bath shower, low-level WC and pedestal wash basin.

Bedroom 2 8' 10" x 12' 10" (2.70m x 3.92m)

Well-sized double bedroom to the front aspect of the property, window to the front aspect of the property. Carpeted throughout.

11 Lanes End

TOTAL AREA: 53.87 m² · LIVING AREA: 53.87 m² · FLOORS: 2 · ROOMS: 7



▼ Ground Floor

TOTAL AREA: 26.52 m² · LIVING AREA: 26.52 m² · ROOMS: 3

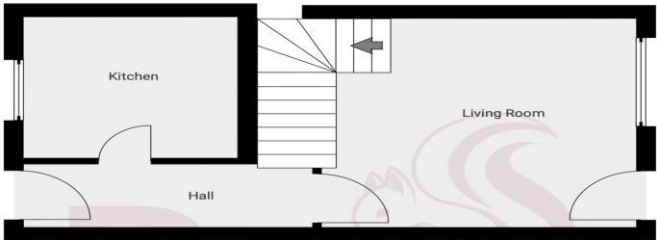

▼ 1st Floor

TOTAL AREA: 27.35 m² · LIVING AREA: 27.35 m² · ROOMS: 4

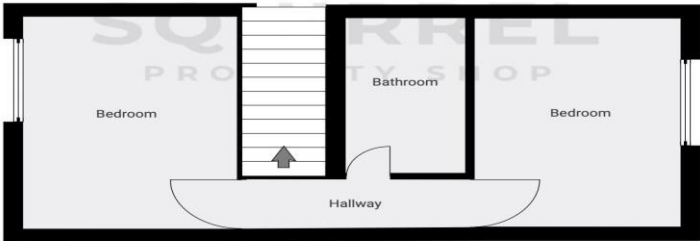

THIS FLOOR PLAN IS PROVIDED WITHOUT WARRANTY OF ANY KIND. SENSOPRA DISCLAIMS ANY WARRANTY INCLUDING, WITHOUT LIMITATION, SATISFACTORY QUALITY OR ACCURACY OF DIMENSIONS.

