

Alvington Manor View Newport, PO30 5NZ

£170,000



Offered CHAIN FREE!! This 2 bedroom terraced house is located in a quiet cul-de-sac location on the outskirts of Newport town centre and close to Carisbrooke, it is within easy reach of local schools shops and Carisbrooke village. The property consists of a kitchen, living room, kitchen, two double bedrooms and a family bathroom. Outside offers a garden and patio area. Other benefits of the property includes loft access, double glazing and gas central heating. This is perfect for first time buyers alternatively investors!!

CHAIN FREE!!

TERRACED HOUSE

GREAT FOR FIRST TIME BUYERS!!

2 BEDROOMS

CLOSE TO LOCAL SCHOOLS & SHOPS

DOUBLE GLAZING & GAS CENTRAL HEATING

ROOMS

Entrance Porch

Hallway

Kitchen 10' 2" x 6' 8" (3.10m x 2.03m)

Laminate flooring. Fitted-kitchen with Gas hob & electric oven. Sink drainer and room for white goods. Double glazed window to front aspect.

Living room 13' 9" x 12' 8" (4.19m x 3.86m)

Wooden flooring. Double glazed window & door to rear aspect leading on to the garden. Radiator.

Family bathroom

Laminate flooring. Fitted-bath with over head shower, sink & WC.

Bedroom 1 9' 8" x 9' 5" (2.94m x 2.87m)

Wooden flooring. Double fitted wardrobes. Double glazed window to rear aspect.

Bedroom 2 12' 9" x 8' 0" (3.88m x 2.44m)

Wooden flooring. Double glazed window to front aspect. Radiator.

Landing

Project 12

44 Alvington Manor View, PO20 5NZ Newport
TOTAL AREA: 724.38 sq ft - LIVING AREA: 580.49 sq ft - FLOORS: 2 - ROOMS: 7



▼ Ground Floor

TOTAL AREA: 456.46 sq ft - LIVING AREA: 433.36 sq ft - ROOMS: 3

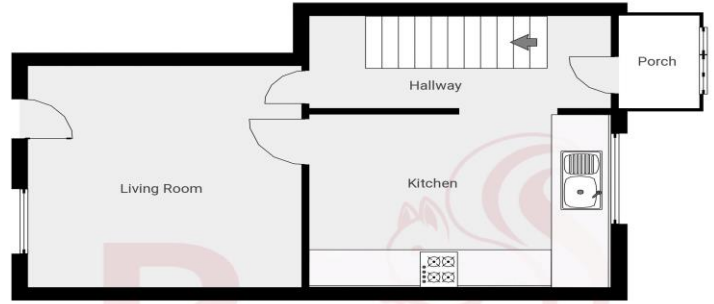

▼ 1st Floor

TOTAL AREA: 267.92 sq ft - LIVING AREA: 147.13 sq ft - ROOMS: 4

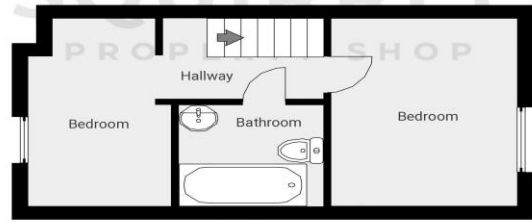

THIS FLOOR PLAN IS PROVIDED WITHOUT WARRANTY OF ANY KIND. SENSORIA DISCLAIMS ANY WARRANTY INCLUDING, WITHOUT LIMITATION, SATISFACTORY QUALITY OR ACCURACY OF DIMENSIONS.

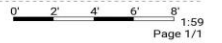

| Energy Efficiency Rating | | Current | Potential |
|---|----------|-------------------------|-----------|
| Very energy efficient - lower running costs | | | |
| (92+) | A | | |
| (81-91) | B | | 89 |
| (69-80) | C | | |
| (55-68) | D | 59 | |
| (39-54) | E | | |
| (21-38) | F | | |
| (1-20) | G | | |
| Not energy efficient - higher running costs | | | |
| England, Scotland & Wales | | EU Directive 2002/91/EC | |