

49a Steyne Road Bembridge, PO35 5SL

£400,000



A pair of traditionally built semi-detached house situated in the heart of Bembridge village. Downstairs W/C in each property with upstairs bathroom and a En-suite in the three bedroom option. Both properties offer off road parking for 2 cars at the front of the property & a enclosed rear garden which has a patio and laid to lawn.

TRADITIONALLY BUILT

DOWNSTAIRS WC

OFF ROAD PARKING FOR 2

3 BEDROOM SEMI-DETACHED HOUSE

UPSTAIRS BATHROOM

ENCLOSED REAR GARDEN

ROOMS

Hallway

Downstairs WC 6' 3" x 2' 7" (1.9m x 0.8m)

LVT Flooring. WC & Sink. Double glazed frosted window to front aspect.

Open Plan kitchen/Living area 32' 6" x 15' 1" (9.9m x 4.6m)

LVT flooring. New-fitted kitchen with new electric hob & oven. Wine fridge. Sink drainer. Ceiling lights. Double glazed windows to front & side aspect. Double glazed bi-fold doors to rear aspect leading on to the patio area.

Cupboard

Landing

Bedroom 1 10' 6" x 13' 5" (3.2m x 4.1m)

Carpet flooring. Double glazed windows to front aspect. Radiator. Storage cupboard/cloakroom.

En-suite 6' 11" x 4' 7" (2.1m x 1.4m)

Wood effect laminate flooring. Walk-in shower. Sink basin & WC. Heated Towel rail.

Family Bathroom 8' 6" x 5' 11" (2.6m x 1.8m)

Wood effect laminate flooring. Bath & walk-in shower. Sink basin & WC. Heated towel rail. Double glazed frosted window to side aspect.

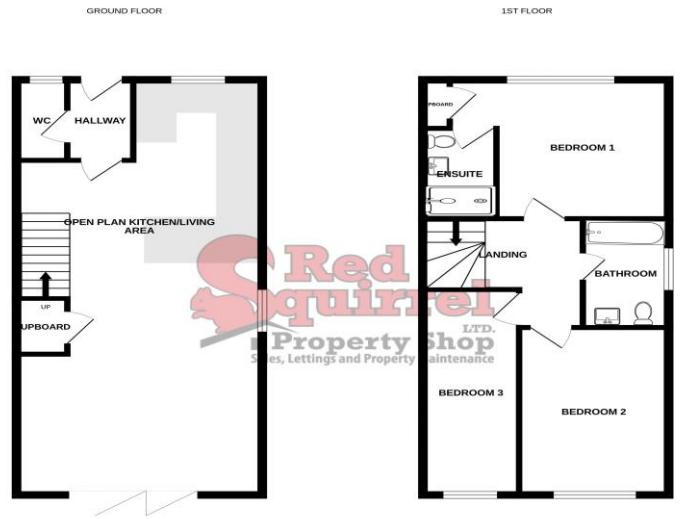

Whilst every attempt has been made to ensure the accuracy of the floorplan, the measurements of rooms, fixtures, fittings and any other items are approximate and no responsibility is taken for any error, omission or mis-statement. The floor plan is for general guidance only and should not be relied upon for any specific purpose. The floor plan is not a contract and does not constitute an offer. It is the responsibility of the client to verify the accuracy of the floor plan. Please call 0204 5123 4567

Bedroom 2 13' 1" x 9' 2" (4m x 2.8m)

Carpet flooring. Two double glazed windows to rear aspect. Radiator.

Bedroom 3 13' 9" x 3' 11" (4.2m x 1.2m)

Carpet flooring. Double glazed window to rear aspect. Radiator.

