



PENRHYN COTTAGE, 48 MAIN STREET,
EBBERSTON, NORTH YORKSHIRE, YO13 9NS
PRICE GUIDE £560,000

A picturesque, renovated, period cottage with outbuildings nestling in this attractive and sought after village on a large plot (approximately 0.45 acre) with huge potential.

This single storey property has the benefit of gas fired central heating and sealed unit UPVC double glazing. It includes rear entrance hall/utility; shower room; an outstanding, open plan, vaulted kitchen/dining/living space with wood burning stove and French doors to the rear garden; sitting room with wood burning stove; front entrance hall; two double bedrooms and bathroom.

Externally to the side, there is off-road car standing and a substantial serviced garage/workshop plus adjacent store with exceptional potential for further development, subject to the appropriate consents. Extensive gardens at the rear include a greenhouse, summer house, well-stocked flower beds, mature trees, lawns and a pond. Beyond these gardens there is a large car standing area, storage sheds and access to the electricity supply including an electric hook-up for a motorhome or caravan with plenty of room for parking multiple vehicles. A graveled drive leads from here to the back lane, to the side of which is a large lawn with mature trees.

The village is ideally located just outside the North York Moors National Park with Dalby & Cropton Forests, the Yorkshire Wolds and Coast nearby. The City of York and the market towns of Pickering and Malton are easily accessible.





Ground Floor
Approx. 29.3 sq. metres (315.3 sq. feet)

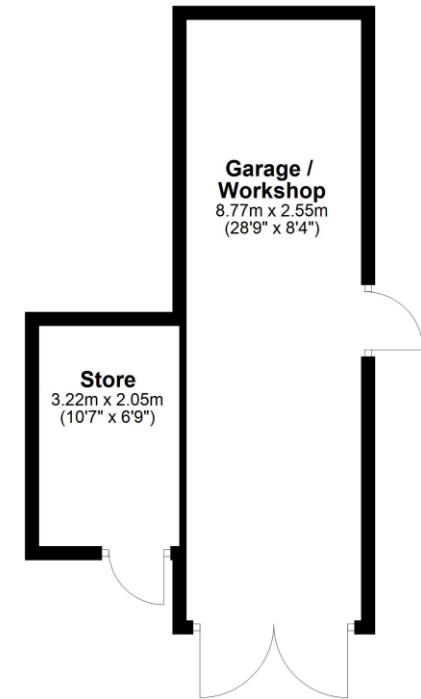

Total area: approx. 29.3 sq. metres (315.3 sq. feet)
Outbuildings, 48 Main Street

Ground Floor
Approx. 108.6 sq. metres (1168.9 sq. feet)

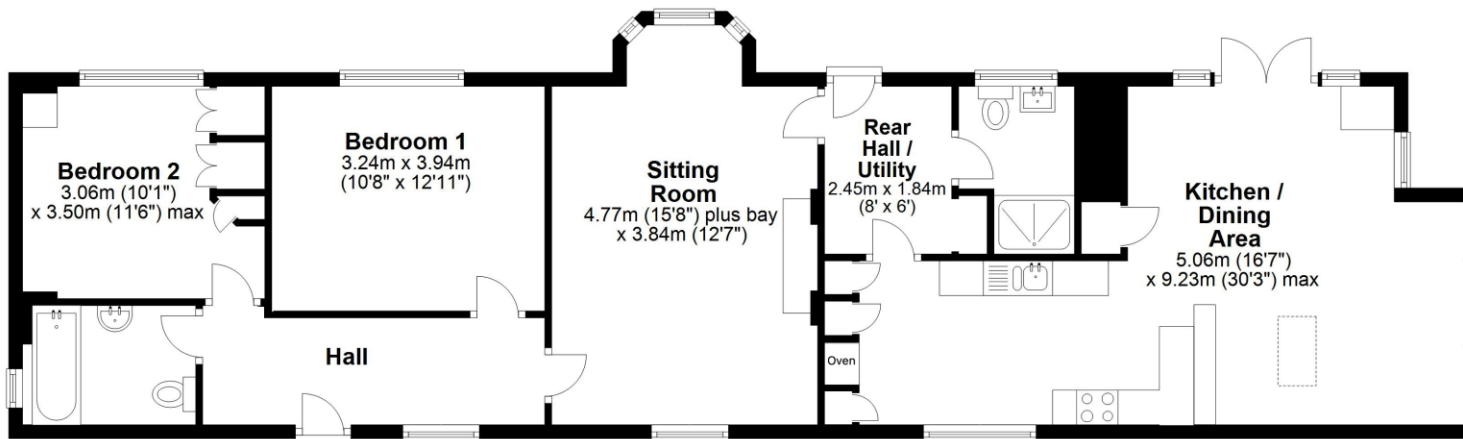

Total area: approx. 108.6 sq. metres (1168.9 sq. feet)

48 Main Street, Eberston

For illustration purposes only not to scale





Tenure: Freehold. Vacant possession will be given on completion.

Services: Mains water, drainage, gas and electricity are laid on.

Energy Performance Rating: Band D

Property Tax: Band E

Viewing: Strictly by appointment through the Agents Pickering Office, Champley's Mews, Market Place, Pickering, YO18 7AE, Tel: 01751 475557.

Need advice on buying through another agent? Contact Peter Illingworth on 01751 475557 to discuss how we can give you the comfort of many years of our expertise, in representing clients in the purchase of their next home.

Need to sell your own property? Contact Peter Illingworth on 01751 475557 for no-obligation advice.



www.peterillingworth.co.uk

16 Market Place, Kirkbymoorside, York, YO62 6DA
T. 01751 431107
E. kirkbymoorside@peterillingworth.co.uk

Champley's Mews, Market Place, Pickering, North Yorkshire, YO18 7AE
T. 01751 475557
E. pickering@peterillingworth.co.uk

41-43, Maddox Street, London, W15 2PD
T. 08701 127 099
E. info@mayfairoffice.co.uk W. www.mayfairoffice.co.uk



Important Notice:

- Peter Illingworth Estate Agents for themselves and for the Vendors or Lessors of this property, whose agents they are; give notice that:
- the particulars are set out as a general outline only for the guidance of intending purchasers or lessees and do not constitute, nor constitute part of, an offer or contract;
 - all descriptions, dimensions, references to condition and necessary permissions for use and occupation and other details are given without responsibility and any intending purchasers or tenants should not rely on them as statements or representatives of fact but must satisfy

- themselves, by inspection or otherwise, as to the correctness of each of them;
 - no person in the employment of Peter Illingworth Estate Agents has any authority to make or give any representation or warranty given whether by Peter Illingworth Estate Agents and Associates or the Vendors or the Lessors of this property.
- It is the responsibility of any intending purchaser to satisfy himself as to the accuracy of any information upon which he relies in making an offer. The making of any offer for this property will be taken as an admission by the intending purchaser that he has relied solely upon his own personally verified information, inspection and enquiries.