

Peter  
**illingworth**  
ESTATE AGENTS

**14, Bridge Row, Kirkbymoorside,  
Kirkbymoorside, YO62 6FQ  
Price Guide £335,000**

[www.peterillingworth.co.uk](http://www.peterillingworth.co.uk)



**With fabulous west-facing views over rolling open countryside, this home occupies one of the most enviable locations on this popular modern estate.**

A well-presented, timber framed, sealed unit double glazed, gas-fired centrally heated, three-bedroom detached family home situated on the periphery of the ancient market town of Kirkbymoorside. Ideally located to enjoy the North York Moors National Park, it also offers easy access to the historic market towns of Pickering and Helmsley, both just a short drive away.

**Accommodation briefly comprises:**

**Ground Floor:** Front entrance lobby, sitting room, open-plan fitted kitchen/dining/family room with double doors leading to the rear garden, inbuilt utility room, cloakroom, and integral garage.

**First Floor:** Landing, three bedrooms including a principal bedroom with en-suite shower room, and a house bathroom with separate shower.

**Externally:**

To the front, there is car standing space for two vehicles, a lawned garden, and a well stocked border. The fully enclosed rear garden features a patio, lawn and well-stocked borders.

Kirkbymoorside benefits from an excellent primary school and falls within the catchment area of the highly regarded Ryedale School.

The ancient city of York, along with the coastal resorts of Scarborough and Whitby, are all within commuting distance.





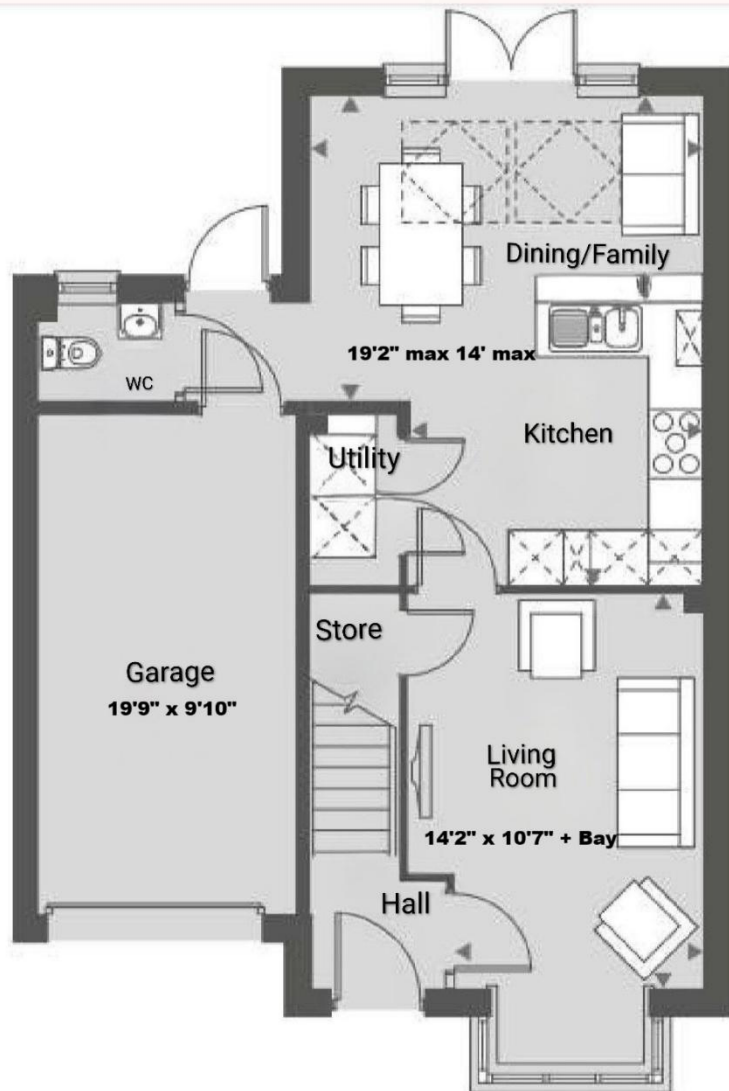

For information purposes, not to scale







**Tenure:** We understand the property to be freehold and vacant possession will be given on completion.

**Services:** Mains water, drainage, gas and electricity are laid on.

**EPC:** Band B

**Property Tax:** Band D

**Broadband:**

Basic 17 Mbps, Superfast 41 Mbps, Ultrafast 1,800 Mbps

**Note:** The house is on a private road any costs to be shared between 5 properties.

**Mobile Coverage:**

EE, Vodafone, Three and O2

**Satellite/Fibre TV availability :** BT and Sky

**Flood Risk:** Very low

**What3Words:** ///harsh.socialite.material

**Photography:** By Peter Illingworth

**HMRC:** It is a legal requirement to identify purchasers for the Proceeds of Crime Act/Anti-Money Laundering/ Anti Terrorism Legislation etc. For these purposes this service is contracted out to Landmark Estate Agency Services for which they will apply a charge.

**Need to sell your own property?** Contact Peter Illingworth on 01751 431107 for no-obligation advice.

**Viewing:**

Strictly by appointment through the Agents Kirkbymoorside Office, 16 Market Place, Kirkbymoorside, York. Tel: 01751 431107



16 Market Place, Kirkbymoorside,  
York, YO62 6DA

T. 01751 431107

E. kirkbymoorside@peterillingworth.co.uk

T. 01751 475557

E. maltonhub@peterillingworth.co.uk

T. 01751 475557

E. pickering@peterillingworth.co.uk

[www.peterillingworth.co.uk](http://www.peterillingworth.co.uk)

41-43, Maddox Street, London, W1S 2PD

T. 08701 127 099

E. info@mayfairoffice.co.uk W. [www.mayfairoffice.co.uk](http://www.mayfairoffice.co.uk)



**Important Notice:**

Peter Illingworth Estate Agents for themselves and for the Vendors or Lessors of this property, whose agents they are; give notice that:

- i) the particulars are set out as a general outline only for the guidance of intending purchasers or lessees and do not constitute, nor constitute part of, an offer or contract;
- ii) all descriptions, dimensions, references to condition and necessary permissions for use and occupation and other details are given without responsibility and any intending purchasers or tenants should not rely on them as statements or representatives of fact but must satisfy

themselves, by inspection or otherwise, as to the correctness of each of them;

- iii) no person in the employment of Peter Illingworth Estate Agents has any authority to make or give any representation or warranty given whether by Peter Illingworth Estate Agents and Associates or the Vendors or the Lessors of this property.

It is the responsibility of any intending purchaser to satisfy himself as to the accuracy of any information upon which he relies in making an offer. The making of any offer for this property will be taken as an admission by the intending purchaser that he has relied solely upon his own personally verified information, inspection and enquiries.