



Anson Road, NW2

Leasehold - £475,000

For Sale and offered Chain Free is this well-presented First Floor, two bedroom flat, situated within a period property in the heart of Willesden Green.

Spanning over 673 sq ft, the property benefits from a large bright reception room with bay windows, a fully equipped kitchen with ample cupboard storage and dining table, two spacious double bedrooms with fitted wardrobes and a family bathroom.

Anson Road is conveniently located within a short walk to the green open space of the beautiful 86-acre Gladstone Park, with its outdoor gym, tennis courts, pond, and cafés. Walm Lane and Willesden Green are also close by with a diverse selection of individual shops, bars, restaurants, and cafes. Nuffield Sports Centre and South Hampstead Tennis Club and Willesden Green (Jubilee- Zone 2) Station are all a short walk away. The property also enjoys excellent access into Central London along with good road links to A406, M1, and A40 all easily accessible.

- 2 bedroom period conversion First Floor flat
- Offered vacant and CHAIN FREE
- Transport: Willesden Green (Jubilee- Zone 2)
- COUNCIL: Brent (C)

020 7328 2828

enquiries@cameronsstiff.co.uk

cameronsstiff.co.uk



Anson Road, Willesden Green, London, NW2

Approximate Area = 673 sq ft / 62.5 sq m

For identification only - Not to scale

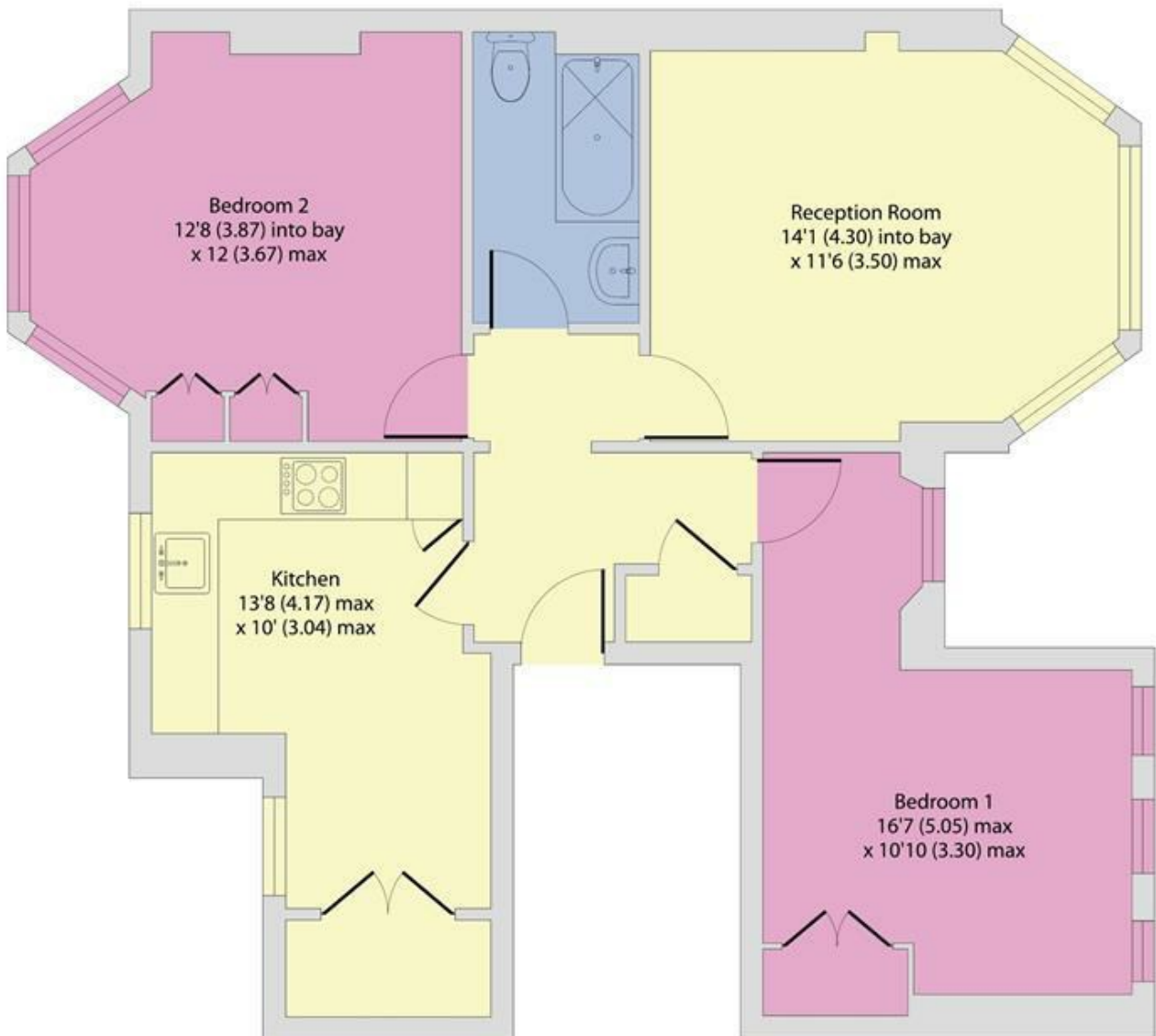

FIRST FLOOR

EPC: C
Ref: 15061649



Floor plan produced in accordance with RICS Property Measurement 2nd Edition, Incorporating International Property Measurement Standards (IPMS2 Residential). © nichecom 2025. Produced for Camerons Stiff & Co. REF: 1357717

