



## Melrose Avenue, NW2

Freehold - £750,000

We are delighted to offer For Sale this huge 1,238 sqft four bedroom, First Floor maisonette with its own private parking space and a section of garden.

One of the largest flats we have seen in the area, this very unique flat offers huge potential for an incoming buyer to refurbish, develop and design to their style and standard. Offered with leasehold and whole freehold, there is further potential for a loft conversion subject to planning and necessary consent.

Melrose Avenue is just moments from Willesden Green and Cricklewood Broadway, offering a vibrant selection of local bars, restaurants, and the lush 86-acre Gladstone Park. Transport links are excellent, with Willesden Green (Jubilee Zone 2) and Dollis Hill (Jubilee Zone 3) nearby with easy access to the North Circular.

- 1,238 sqft 4 bedroom, First Floor maisonette
- Loft conversion subject to planning
- Close to local amenities
- COUNCIL: Brent (D)

020 7328 2828

[enquiries@cameronsstiff.co.uk](mailto:enquiries@cameronsstiff.co.uk)

[cameronsstiff.co.uk](http://cameronsstiff.co.uk)



## Melrose Avenue, London, NW2

Approximate Area = 1238 sq ft / 115.1 sq m

For identification only - Not to scale

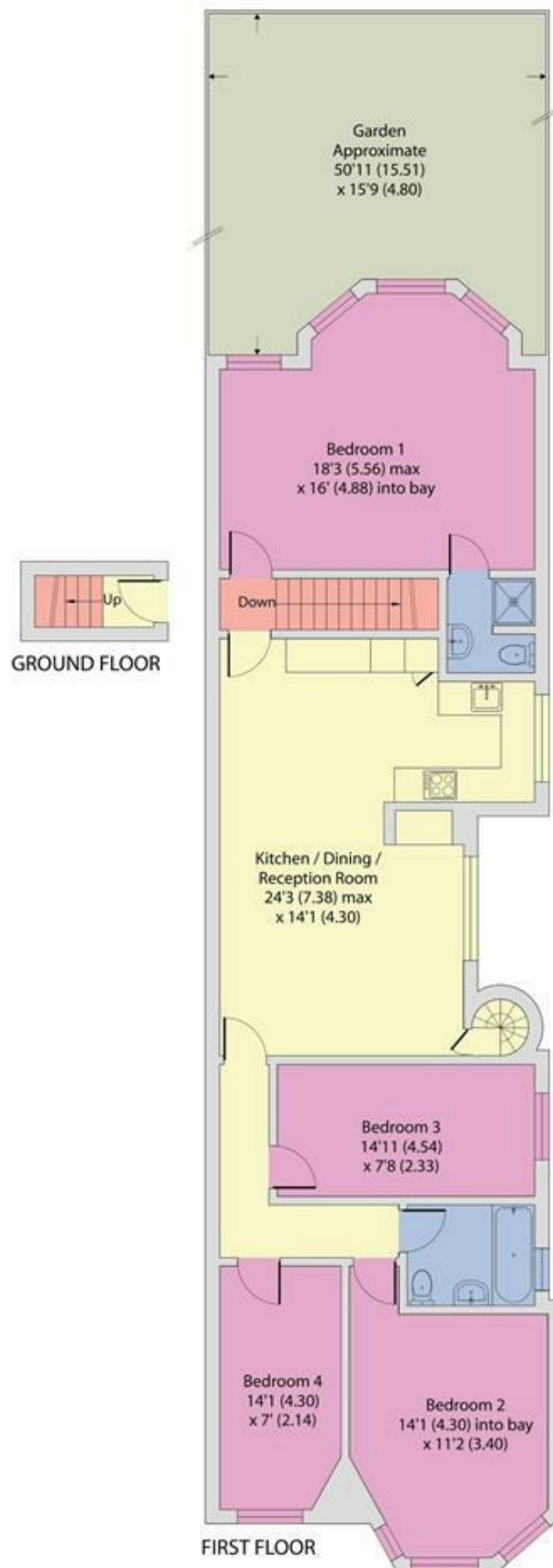

**EPC: C**  
Ref: 19381479



Floor plan produced in accordance with RICS Property Measurement 2nd Edition, Incorporating International Property Measurement Standards (IPMS2 Residential). Produced for Camerons Stiff & Co. REF: 1291255. © nitchecom 2025.

