



Brondesbury Road, NW6

Share of Freehold - Offers Over: £900,000

For Sale is this well-presented two bedroom flat, offering 971 sq ft of stylish living space that occupies the entire First Floor of this converted three-storey, double fronted period house.

The apartment offers a south-facing open plan kitchen/reception room leading onto a separate 13 ft living room with double doors for extra privacy. There are also two spacious double bedrooms both with built in wardrobes serviced by the modern family bathroom with a separate shower. Further benefits include wooden flooring, fitted carpets, sash windows and an original feature fireplace in the front living room.

Brondesbury Road is a sought-after, tree-lined residential road situated just off Salusbury Road with its cafés, independent bistros, and grocery shops. Excellent transport links include Queen's Park (Bakerloo & Overground - Zone 2) and Kilburn (Jubilee - Zone 2).

- 2 bedroom stylish flat - 971 sq ft
- Stylish elegant accommodation
- Short walk to Queen's Park recreation ground
- COUNCIL - Brent (D)

020 7328 2828

enquiries@cameronsstiff.co.uk

cameronsstiff.co.uk







Brondesbury Road, London, NW6

Approximate Area = 971 sq ft / 90 sq m

For identification only - Not to scale

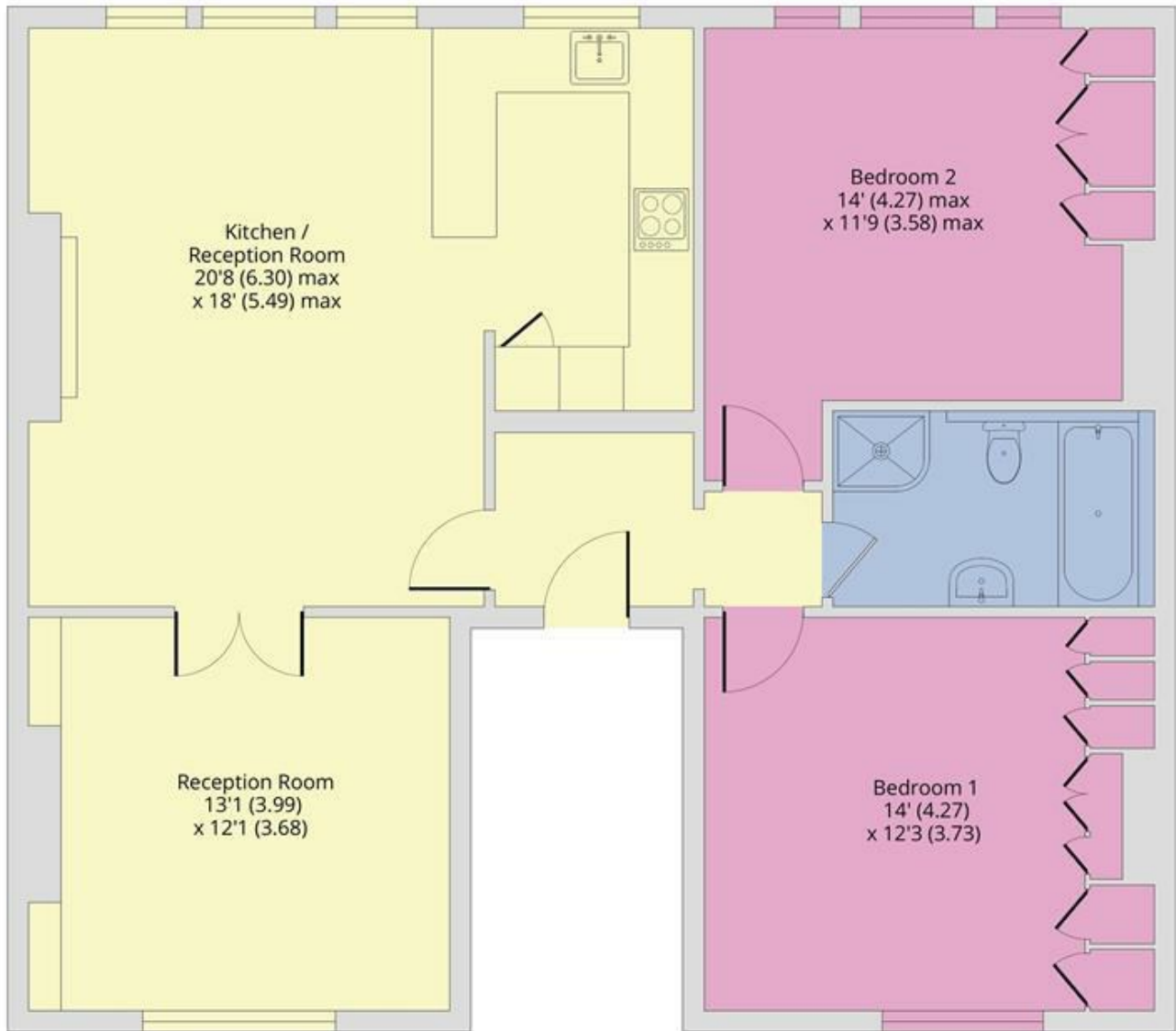

FIRST FLOOR

EPC: C

Ref: 18004602



Floor plan produced in accordance with RICS Property Measurement Standards incorporating International Property Measurement Standards (IPMS2 Residential). © nichecom 2024.
Produced for Camerons Stiff & Co. REF: 832575

