



Thanet Lodge, Mapesbury Road, NW2

Leasehold - £450,000

Offered CHAIN FREE - For Sale is this well-presented and light-filled Ground Floor, three bedroom 818 sq foot apartment that is set within this grand Mansion Block.

This spacious property provides a large reception room, well-appointed kitchen, three generous-sized bedrooms and a family bathroom. Additional benefits include wooden flooring and superb, beautifully kept communal gardens providing a tranquil place to relax.

Mapesbury Road is a popular tree-lined road in the Mapesbury Conservation Area with great transport links. Perfectly located for the nearby bars, shops, restaurants and parks of Kilburn, Queens Park and West Hampstead.

- Offered CHAIN FREE - 3 bedroom apartment - 881 sq ft
- Large bright reception room and kitchen
- Superb communal gardens
- Kilburn (Jubilee - Zone 2) Brondesbury (Overground - Zone 2)
- COUNCIL: Brent (D)
- Viewing is highly recommended

020 7328 2828

enquiries@cameronsstiff.co.uk

cameronsstiff.co.uk



Mapesbury Road, London, NW2

Approximate Area = 818 sq ft / 76 sq m

For identification only - Not to scale

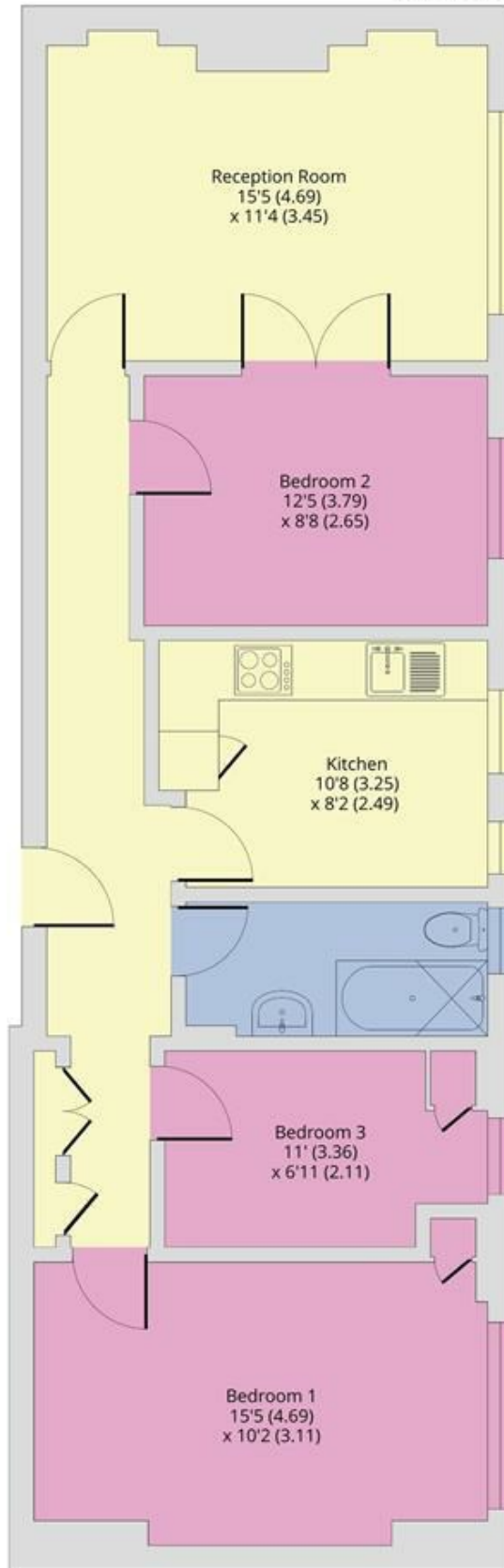

GROUND FLOOR

EPC: D

Ref: 18874947



Floor plan produced in accordance with RICS Property Measurement Standards incorporating International Property Measurement Standards (IPMS2 Residential). © nichecom 2024. Produced for Camerons Stiff & Co. REF: 1107681

