



## Thanet Lodge, Mapesbury Road, NW2

### Leasehold - £550,000

Offered CHAIN FREE, For Sale is this well-presented and light-filled ground floor, three bedroom 818 sq foot apartment. Set in a grand mansion block and nestled between Kilburn and Queens Park.

This spacious property provides a large reception room, well-appointed kitchen, three generous-sized bedrooms and a family bathroom. Additional benefits include wooden flooring and superb communal garden.

Mapesbury Road is a popular tree-lined road in the Mapesbury Conservation Area with great transport links. Perfectly located for the nearby bars, shops, restaurants and parks of Kilburn, Queens Park and West Hampstead.

- Offered CHAIN FREE
- 3 bedroom apartment offering 818 sq ft
- Communal garden
- Kilburn (Jubilee - Zone 2) Brondesbury (Overground - Zone 2)
- COUNCIL: Brent (D)

020 7328 2828

[enquiries@cameronsstiff.co.uk](mailto:enquiries@cameronsstiff.co.uk)

[cameronsstiff.co.uk](http://cameronsstiff.co.uk)



## Mapesbury Road, London, NW2

Approximate Area = 818 sq ft / 76 sq m

For identification only - Not to scale

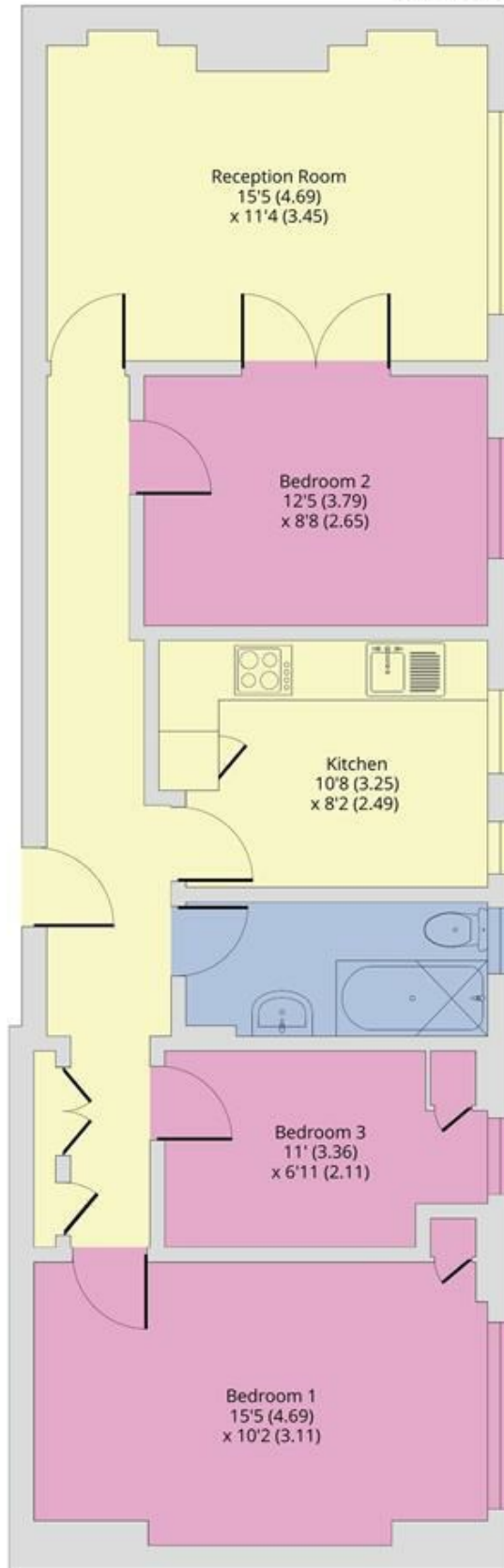

GROUND FLOOR

EPC: D

Ref: 18874947



Floor plan produced in accordance with RICS Property Measurement Standards incorporating International Property Measurement Standards (IPMS2 Residential). © nichecom 2024. Produced for Camerons Stiff & Co. REF: 1107681

