



Keats Road

Aylesford ME20 6TR

£360,000



COUNTRY HOMES

Aylesford ME20 6TR

Nestled in the sought-after area of Larkfield, Aylesford, this charming terraced house on Keats Road offers a delightful blend of comfort and convenience. With three well-proportioned bedrooms, this property is ideal for families or those seeking extra space. The inviting reception room provides a warm and welcoming atmosphere, perfect for relaxation or entertaining guests.

The house features a practical bathroom, ensuring that daily routines are both efficient and comfortable. One of the standout features of this property is the driveway, providing off-road parking—a valuable asset in this popular location.

Situated close to the M20, residents will benefit from excellent transport links, making commuting a breeze. The surrounding area boasts a variety of local amenities, including shops, schools, and parks, catering to all your daily needs.

This property presents a wonderful opportunity to secure a home in a vibrant community, where convenience meets comfort. Whether you are a first-time buyer or looking to invest, this terraced house on Keats Road is certainly worth considering.

- Popular Location
- Driveway
- Ideal for First Time Buyers
- 3 Bedrooms
- Kitchen with Breakfast Bar
- Rear Garden
- Close to M20 and Transport Links into London
- Viewing Encouraged



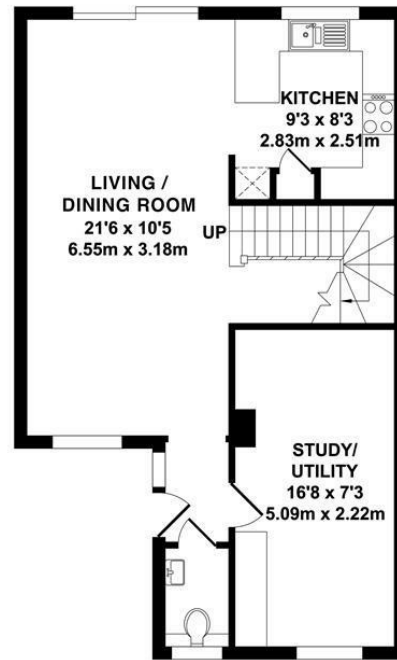

GROUND FLOOR
APPROX. FLOOR AREA
537 SQ.FT.
(49.91 SQ.M.)

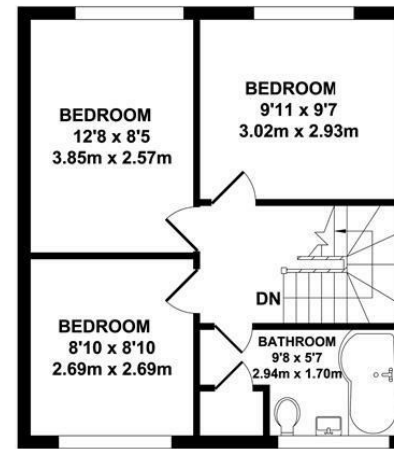

FIRST FLOOR
APPROX. FLOOR AREA
408 SQ.FT.
(37.92 SQ.M.)

TOTAL APPROX. FLOOR AREA 945 SQ.FT. (87.83 SQ.M.)

Whilst every attempt has been made to ensure the accuracy of the floor plan contained here, measurements of doors, windows, rooms and any other items are approximate and no responsibility is taken for any error, omission or mis-statement. This plan is for illustrative purposes only and should be used as such by any prospective purchaser. The services, systems and appliances shown have not been tested and no guarantee as to their operability or efficiency can be given.

Zome Media ©2025

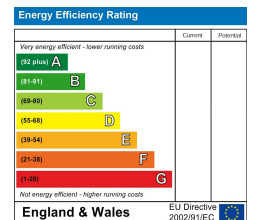





Location Map

Tenure: Freehold

Council tax band: D

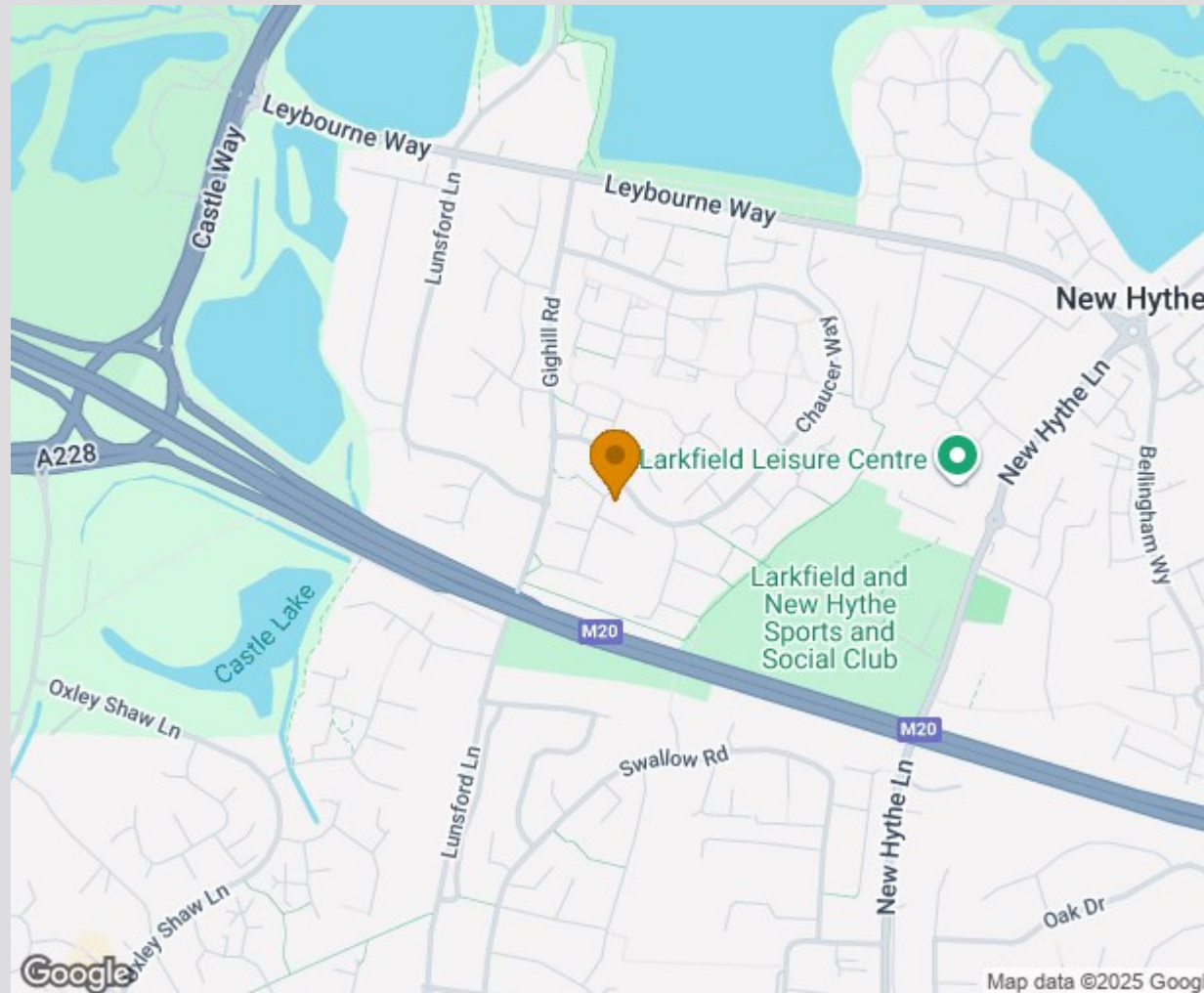

TO VIEW CONTACT: 01732 87 11 11 westmallings@khp.me

www.khp.me



Zoopla.co.uk
Smarter property search

