



5 The Sidings, Norwich

£260,000 Freehold

Situated in a desirable residential area within walking distance to Norwich city centre, this well-presented two-bedroom mid-terrace house is offered with no onward chain, making it an excellent opportunity for first-time buyers or those looking for a straightforward move. Thoughtfully designed and built to a high standard with quality German craftsmanship, the home offers a bright and welcoming lounge, a well-appointed fitted kitchen with space for dining, and a convenient ground-floor cloakroom. Upstairs, you'll find two generous double bedrooms with built-in cupboards and a modern family bathroom. Outside, the property continues to impress with off-road parking and a south-facing, low-maintenance rear garden, creating a practical and comfortable home in a sought-after location.

Situated in a desirable residential area within walking distance to Norwich city centre, this well-presented two-bedroom mid-terrace house is offered with no onward chain, making it an excellent opportunity for first-time buyers or those looking for a straightforward move. Thoughtfully designed and built to a high standard with quality German craftsmanship, the home offers a bright and welcoming lounge, a well-appointed fitted kitchen with space for dining, and a convenient ground-floor cloakroom. Upstairs, you'll find two generous double bedrooms with built-in cupboards and a modern family bathroom. Outside, the property continues to impress with off-road parking and a south-facing, low-maintenance rear garden, creating a practical and comfortable home in a sought-after location.

Location

The Sidings is located in Thorpe Hamlet, a popular area to the east of Norwich city centre. This position offers easy access to the vibrant shops, restaurants, and cultural attractions the city has to offer, all within walking distance. The



Situated in a desirable residential area within walking distance to Norwich city centre, this well-presented two-bedroom mid-terrace house is offered with no onward chain, making it an excellent opportunity for first-time buyers or those looking for a straightforward move. Thoughtfully designed and built to a high standard with quality German craftsmanship, the home offers a bright and welcoming lounge, a well-appointed fitted kitchen with space for dining, and a convenient ground-floor cloakroom. Upstairs, you'll find two generous double bedrooms with built in



Situated in a desirable residential area within walking distance to Norwich city centre, this well-presented two-bedroom mid-terrace house is offered with no onward chain, making it an excellent opportunity for first-time buyers or those looking for a straightforward move. Thoughtfully designed and built to a high standard with quality German craftsmanship, the home offers a bright and welcoming lounge, a well-appointed fitted kitchen with space for dining, and a convenient ground-floor cloakroom. Upstairs, you'll find two generous double bedrooms with built-in cupboards and a modern family bathroom. Outside, the property continues to impress with off-road parking and a south-facing, low-maintenance rear garden, creating a practical and comfortable home in a sought-after location.

Location

The Sidings is located in Thorpe Hamlet, a popular area to the east of Norwich city centre. This position offers easy access to the vibrant shops, restaurants, and cultural attractions the city has to offer, all within walking distance. The nearby train station provides direct links to London and surrounding areas, making it ideal for commuters. Riverside Retail Park is just a short stroll away, offering a variety of restaurants, shops, and a cinema. With scenic riverside walks and green spaces also close by, this location offers the convenience of city living with plenty of leisure options right on the doorstep. The area is well regarded for its community feel and the variety of property styles, attracting professionals, couples, and those who enjoy being close to the centre while still having quieter surroundings.

The Sidings, Norwich

Upon entering through the welcoming bright lounge, you're immediately met with a light-filled space that offers a comfortable and inviting setting for everyday living. This generous room provides the perfect area to relax or entertain, with space for both seating and personal touches.

From here, you are guided through to a well-appointed hall featuring a convenient storage cupboard under the stairs. The ground floor also boasts a conveniently located cloakroom with tiled floors, catering to the need for practicality.

The heart of this home lies in the bright and spacious kitchen, which is well equipped with fitted cupboards, ample counter space, tiled floors, and enough room for dining. A door from the kitchen leads to the outside, allowing for seamless indoor-outdoor living and entertaining options, while the layout ensures a practical and welcoming space for everyday use.



Ground Floor
327 sq.ft. (30.4 sq.m.) approx.

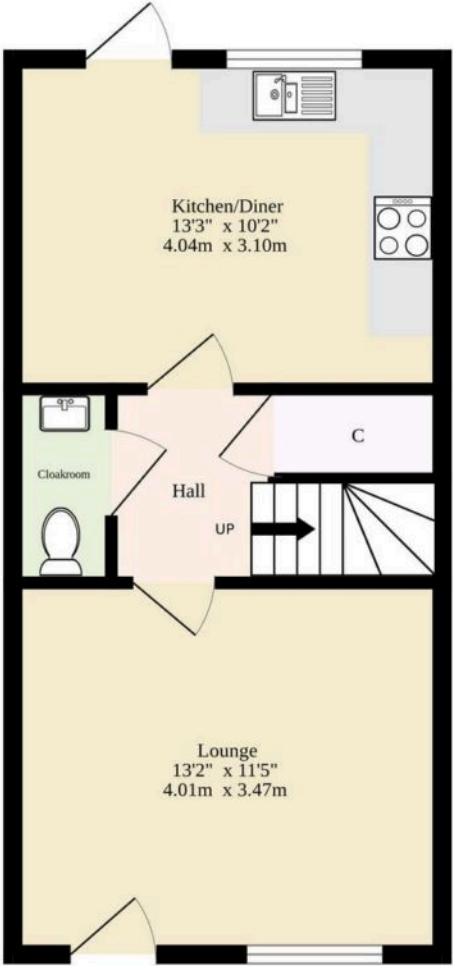

1st Floor
333 sq.ft. (30.9 sq.m.) approx.

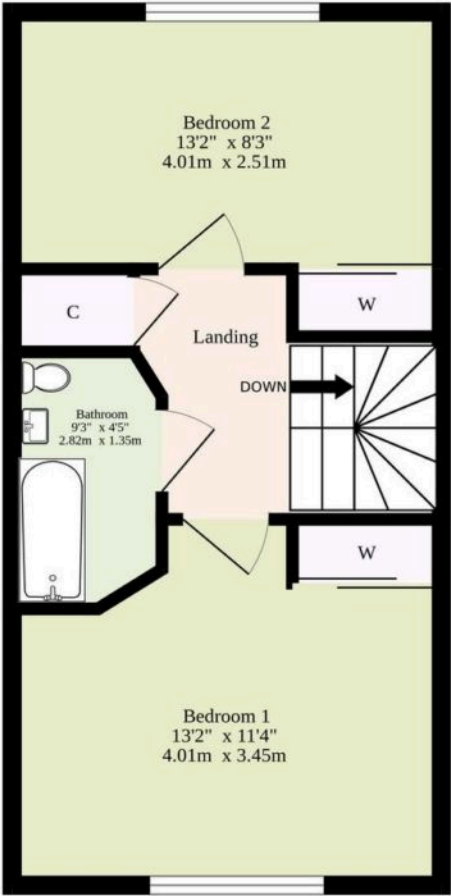

TOTAL FLOOR AREA : 743sq.ft. (69.0 sq.m.) approx.

Whilst every attempt has been made to ensure the accuracy of the floorplan contained here, measurements of doors, windows, rooms and any other items are approximate and no responsibility is taken for any error, omission or mis-statement. This plan is for illustrative purposes only and should be used as such by any prospective purchaser. The services, systems and appliances shown have not been tested and no guarantee as to their operability or efficiency can be given.
Made with Metropix ©2025

You can include any text here. The text can be modified upon generating your brochure.

You can include any text here. The text can be modified upon generating your brochure.

