



15 Harewood Crescent

Elm Tree, Stockton-On-Tees, TS19 0SZ

Offers in excess of £200,000



Nestled In The Desirable Area Of Harewood Crescent, Elm Tree, Stockton-on-tees, This Charming Detached House Presents An Excellent Opportunity For Those Seeking A Comfortable Family Home. With Three Well-proportioned Reception Rooms, This Property Offers Ample Space For Both Relaxation And Entertaining. The Three Bedrooms Provide A Peaceful Retreat, While The Recently Updated Bathroom, Featuring A New En-suite Shower Room, Adds A Touch Of Modern Convenience.

*Offers Invited Around £210,000.



Full Description

One Of The Standout Features Of This Home Is The Converted Sun Room, Which Boasts An Insulated Ceiling, Creating A Delightful Space To Enjoy Throughout The Year. The Generous Private Plot Surrounding The Property Ensures That You Have Plenty Of Outdoor Space For Gardening, Play, Or Simply Enjoying The Fresh Air.

This Home Is Ready To Move Straight Into, Having Been Well-maintained And Updated With A Recently Installed Combi Boiler, Ensuring Warmth And Efficiency. Whether You Are A First-time Buyer Or Looking To Upsize, This Property Offers A Perfect Blend Of Comfort And Practicality In A Sought-after Location. Don't Miss The Chance To Make This Lovely House Your New Home.

Location

Take A Turn Off Elm Tree Avenue Onto Helmsley Grove, Then A Left Onto Harewood Crescent & The Property Sits On The Left-Hand Side.

- Our Lady & St Bede School - 3 Minute Drive / 10 Minute Walk
- White House Primary School - 3 Minute Drive / 10 Minute Walk
- Elm Tree Store - 2 Minute Drive / 5 Minute Walk
- The Elm Tree Pub - 2 Minute Drive / 5 Minute Walk

Distance Times Estimated Using Google Maps.

Note

Please Find The Attached Brochure With Material Information For Buyers.

The Seller Informs Us The Loft Is Insulated & Partially Boarded.

Disclaimer

Although Issued In Good Faith, These Particulars Are Not Factual Representations And Are Not A Part Of Any Offer Or Contract. Prospective Buyers Should Independently Verify The Matters Mentioned In These Particulars. There Is No Authority For Harper & Co Estate Agents Limited Or Any Of Its Employees To Make Any Representations Or Warranties About This Property.

While We Try To Be As Accurate As Possible With Our Sales Particulars, They Are Only A General Overview Of The Property. If There Is Anything In Particular That Is Important To You, Please Contact The Office And We Will Be Happy To Check The Situation For You, Especially If You Are Considering Traveling A Significant Distance To View The Property. The Measurements Provided Are Only For Guidance, Thus They Must Be Regarded As Inaccurate. Please Be Aware That Harper & Co Have Not Tested Any Of The Services, Appliances, Or Equipment In This Property; As A Result, We Advise Prospective Buyers To Commission Their Own Surveys Or Service Reports Before Submitting A Final Offer To Purchase. Money Laundering Regulations:In Order To Avoid Any Delays In Finalising The Sale, Intending Buyers Will Be Required To Provide Identification Documentation At A Later Time. Please Cooperate With Us In This Process.

Area Map



Floor Plans

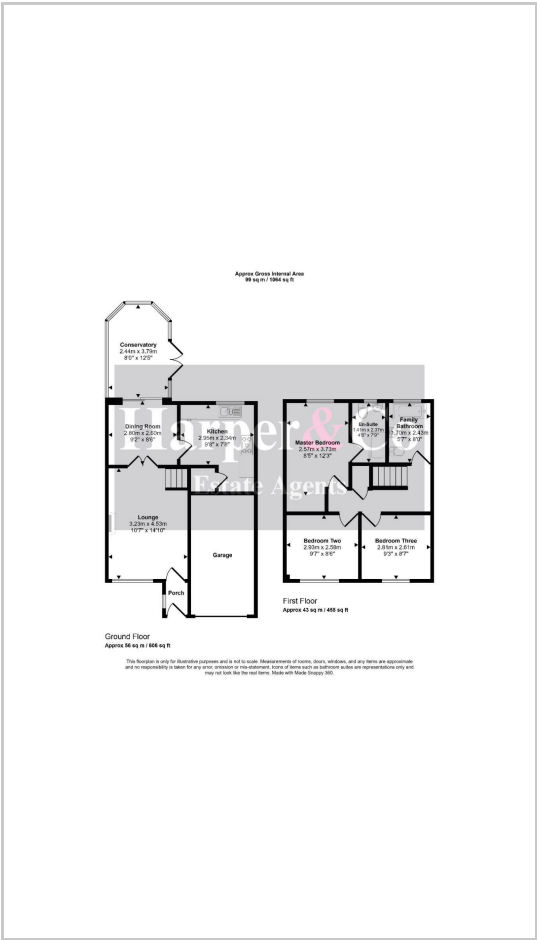

Energy Efficiency Graph

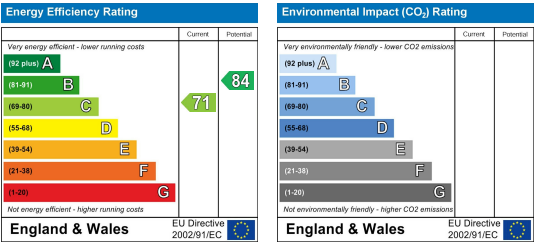

These particulars, whilst believed to be accurate are set out as a general outline only for guidance and do not constitute any part of an offer or contract. Intending purchasers should not rely on them as statements of representation of fact, but must satisfy themselves by inspection or otherwise as to their accuracy. No person in this firms employment has the authority to make or give any representation or warranty in respect of the property.