

Harper & Co

Estate Agents Ltd

<https://www.harperandcoestateagents.co.uk>



The Poplars

Wolviston Village, Billingham, TS22 5LY

Nestled In The Charming Village Of Wolviston, Billingham, This Impressive Detached House At The Poplars Offers A Perfect Blend Of Space And Comfort. With Five Generously Sized Bedrooms, This Property Is Ideal For Families Seeking Room To Grow. The Home Boasts Two Inviting Reception Rooms, Providing Ample Space For Relaxation And Entertaining Guests.

Offers in the region of £400,000

The Poplars

Wolviston Village, Billingham, TS22 5LY



- Extended Five Bedroom Detached House Situated In A Sought After Village Location
- Large Porch, Airy Entrance Hallway & Convenient Ground Floor Cloakroom/W.C
- Generous Enclosed South Facing Rear Garden With Patio Seating Area & Outbuilding
- Within Walking Distance To Many Local Amenities, Reputable Schools & Transport Routes
- Recently Fitted Modern Kitchen/Diner With Integrated Appliances & Quartz Worktops
- Extended Master Bedroom With The Luxury Of An En-Suite Bath & Electric Shower
- Integral Garage With Door To The Hallway Offering Extra Storage Space Or Potential To Convert (STPP)
- Two Spacious Reception Rooms Providing Extra Living Space For Growing Families
- Ample Storage Space Throughout With Four Of Five Bedrooms Benefiting Fitted Wardrobes
- Double Length Driveway Providing Essential Off Road Parking For Multiple Vehicles

Full Description

Location

Note

Disclaimer



Directions



Floor Plan

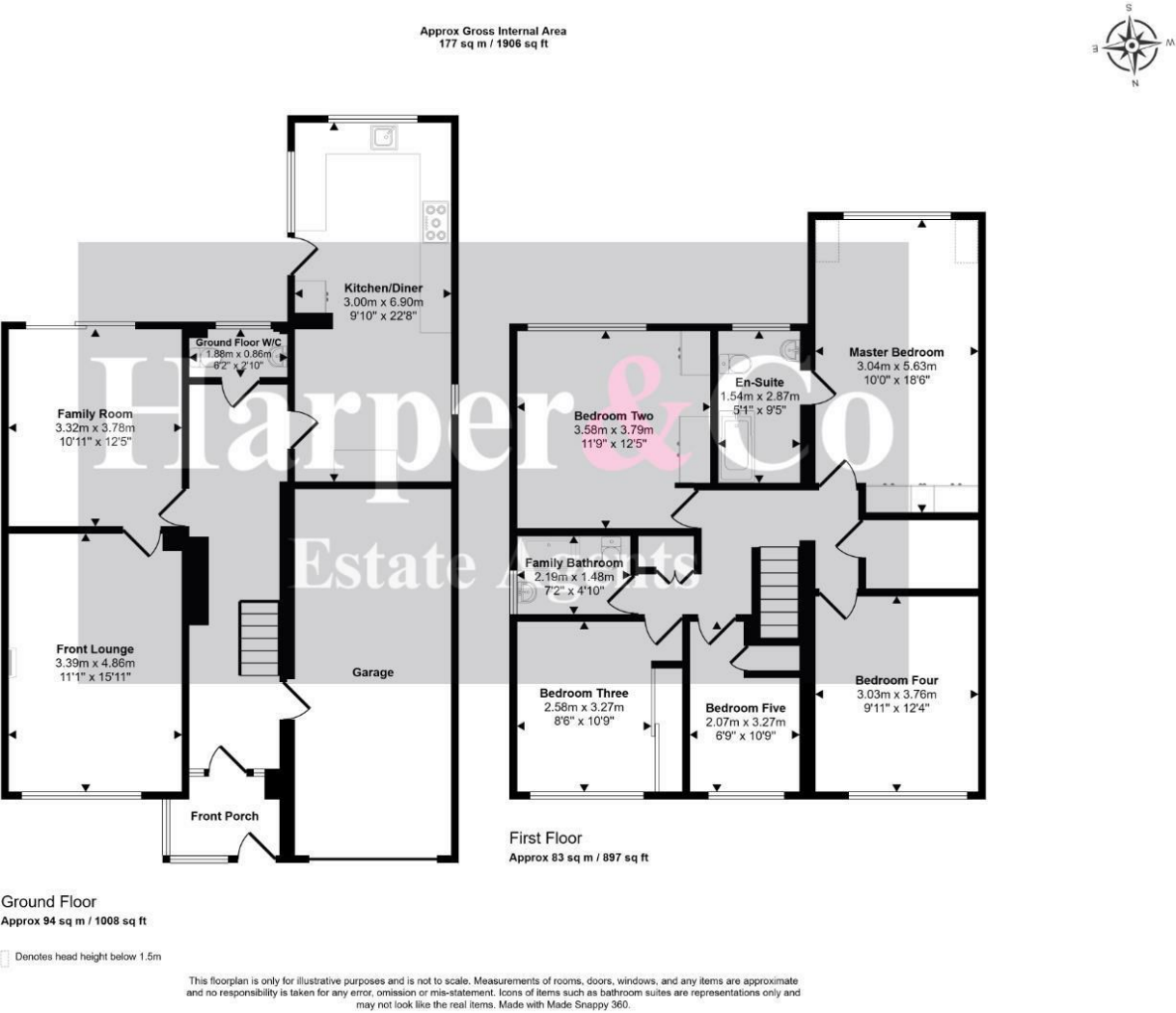

These particulars, whilst believed to be accurate are set out as a general outline only for guidance and do not constitute any part of an offer or contract. Intending purchasers should not rely on them as statements of representation of fact, but must satisfy themselves by inspection or otherwise as to their accuracy. No person in this firms employment has the authority to make or give any representation or warranty in respect of the property.

