



## 5 Benwell Close

Elm Tree, Stockton-On-Tees, TS19 0UH

**Offers in excess of £200,000**



A Charming Detached Bungalow Located In The Sought-After Benwell Close, Elm Tree, Stockton-on-tees. This Property Boasts A Delightful Setting In A Cul De Sac, Offering Peace And Tranquillity.

Upon Entering, You Are Greeted By A Cosy Reception Room, Perfect For Relaxing Or Entertaining Guests. The Bungalow Features Two Lovely Bedrooms, Providing Ample Space For A Small Family.

One Of The Highlights Of This Property Is The Extended Sunroom With Bifold Doors, Allowing Natural Light To Flood The Space And Creating A Seamless Connection To The Outdoors. Imagine Enjoying Your Morning Coffee In This Bright And Airy Room!

The Extended Detached Garage Adds Convenience And Extra Storage Space, While The West-Facing Garden Is Ideal For Soaking Up The Afternoon Sun Or Hosting Summer Barbecues With Friends And Family.



The Vendor Informs Us The Sun Room Roof Is A Lightweight Material With Tile Effect. The Garage Roof Is A Polycarbonate Type Material. The Gas Combi Boiler Is A 'Viasmann' Installed Around 7 Years Ago With An Annual Service History. The Kitchen & Bathroom Are Around 5 Years Old.

**Location**

Take A Turn Off Elm Tree Avenue Onto Barrington Avenue, Then A Left Onto Benwell Close. The Property Sits On The Left-Hand Side.

- Our Lady & St Bede School - 3 Minute Drive / 10 Minute Walk
- White House Primary School - 3 Minute Drive / 10 Minute Walk
- Elm Tree Store - 2 Minute Drive / 5 Minute Walk
- The Elm Tree Pub - 2 Minute Drive / 5 Minute Walk

Distance Times Estimated Using Google Maps.

**Entrance Porch**

uPVC Double Glazed Door & Window, Storage Cupboard, Door Leading To The Hallway.

**Lounge/Dining Room**

18'9" x 10'5" (5.74m x 3.20m)  
Space For A Dining Table & Chairs, Door Leading To The Inner Hallway, Radiator, uPVC Double Glazed Windows x2.

**Bedroom One**

11'8" to fitted wardrobes x 8'9" (3.58m to fitted wardrobes x 2.69m)  
Fitted Wardrobes, Radiator, uPVC Double Glazed Window & Velux Skylight Window.

**Bathroom**

Fitted With A Three Piece White Suite Comprising; Bath With Shower Over, Hand Wash Basin, W/C, uPVC Double Glazed Window, Radiator.

**Inner Hallway**

Doors Leading To The Living Room, Kitchen, Two Bedrooms & Bathroom.

**Bedroom Two**

11'9" x 7'5" ext to 8'8" (3.58m x 2.26m ext to 2.64m )  
Fitted Sliding Wardrobes, Radiator, uPVC Double Glazed Window.

**Kitchen**

9'10" x 8'9" (3.00m x 2.67m)  
Fitted With A Range Of Base, Wall & Drawer Units, Worksurface Incorporating A Sink Unit & Mixer Tap, Built-In Oven, Hob With Extractor Fan Above, Integrated Fridge Freezer, Door Leading To The Garden Room.

**Sun Room**

6'0" x 5'10" (1.83m x 1.80m )  
uPVC Double Glazed Door Bi-Folding Doors Leading To The Rear Garden, Radiator.

**Loft Space**

Partially Boarded With Pull Down Timber Ladder.

**Detached Garage**

20'4" x 10'5" ( 6.22m x 3.18m)  
Remote Controlled Electric Roller Door.

**Energy Efficiency Rating: D**

The Full Energy Efficiency Certificate Is Available On Request.

**Council Tax Band: C**

Council Tax Estimate £2,091

**Disclaimer**

Although Issued In Good Faith, These Particulars Are Not Factual Representations And Are Not A Part Of Any Offer Or Contract. Prospective Buyers Should Independently Verify The Matters Mentioned In These Particulars. There Is No Authority For Harper & Co Estate Agents Limited Or Any Of Its Employees To Make Any Representations Or Warranties About This Property.

While We Try To Be As Accurate As Possible With Our Sales Particulars, They Are Only A General Overview Of The Property. If There Is Anything In Particular That Is Important To You, Please Contact The Office And We Will Be Happy To Check The Situation For You, Especially If You Are Considering Traveling A Significant Distance To View The Property. The Measurements Provided Are Only For Guidance, Thus They Must Be Regarded As Inaccurate. Please Be Aware That Harper & Co Have Not Tested Any Of The Services, Appliances, Or Equipment In This Property; As A Result, We Advise Prospective Buyers To Commission Their Own Surveys Or Service Reports Before Submitting A Final Offer To Purchase. Money Laundering Regulations: In Order To Avoid Any Delays In Finalising The Sale, Intending Buyers Will Be Required To Provide Identification Documentation At A Later Time. Please Cooperate With Us In This Process. (SSTP) Means Subject To Planning Permission.

**Area Map**



**Floor Plans**

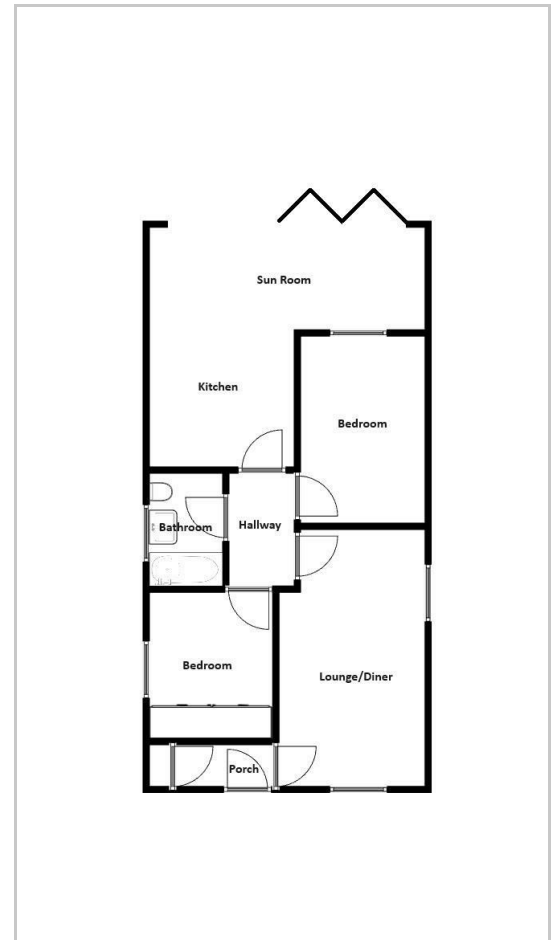

**Energy Efficiency Graph**

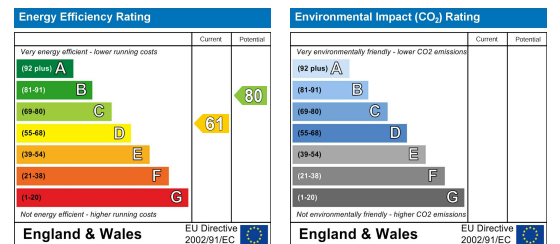

These particulars, whilst believed to be accurate are set out as a general outline only for guidance and do not constitute any part of an offer or contract. Intending purchasers should not rely on them as statements of representation of fact, but must satisfy themselves by inspection or otherwise as to their accuracy. No person in this firms employment has the authority to make or give any representation or warranty in respect of the property.