

RELKO GARDENS

Relko Gardens
Sutton, SM1 4TJ

Offers in the region of £300,000



Relko Gardens, Sutton, SM1 4TJ

Nestled in a prominent position that is convenient for both Sutton and Carshalton, this spacious 2 bedroom first floor apartment offers just so much in this price range. It really is a fantastic opportunity for you to move into what may be your first home, or even rent out if you are looking for that rock-solid investment as this is a coveted development with incredibly well looked after communal grounds reaching around the building, which everyone will appreciate. What's more, the property is offered in excellent condition inside having been updated throughout the sellers occupation, with a well appointed kitchen that has a fabulous amount of workspace for you to really cook up a storm in! This generous sizes are consistent throughout, with 2 bedrooms that are both able to accommodate double beds and modern, refitted bathroom which serves all of the rooms. But we are saving the best until last! The wonderful lounge is the 'jewel in the crown', a room that has ample space for you to not just relax in and catch up on a good book or some great TV, but also perfect for you to have your friends and family come over and entertain in, as the room can easily accommodate a dining area. On the outside, as we mentioned, the location is brilliant. A short walk to fantastic local amenities in Sutton with a fantastic selection of shops and restaurants, with Sutton mainline station whizzing you up to London in under half an hour! For a more village vibe Carshalton is also close by and if you have kids, you'll be ecstatic, as you'll have access to some of the best schools in the country! The final piece of the jigsaw comes by the way of a garage en-bloc, perfect for you not having the issues of having to find a space to park, a fantastic benefit for the lucky new owner!



FIRST FLOOR

Hallway

Living/Dining Room
18'10 x 11'0 (5.74m x 3.35m)

Kitchen
10'8 x 7'3 (3.25m x 2.21m)

Bedroom
13'1 x 8'10 (3.99m x 2.69m)

Bedroom
10'6 x 9'3 maximum (3.20m x 2.82m maximum)

Bathroom
7'3 x 6'3 (2.21m x 1.91m)

OUTSIDE

Garage

Communal Grounds

Area Map



Floor Plan

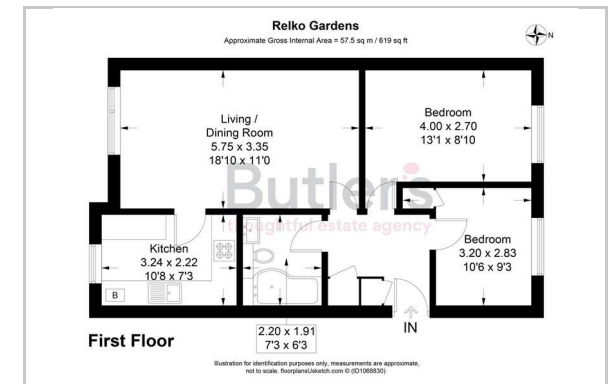

Energy Efficiency Graph

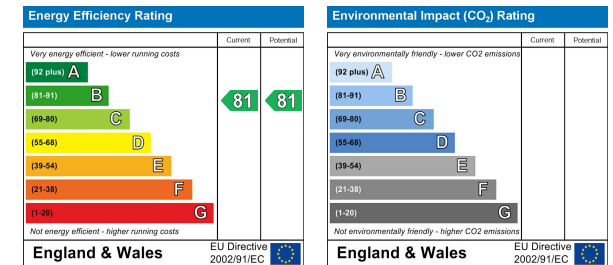

These particulars, whilst believed to be accurate are set out as a general outline only for guidance and do not constitute any part of an offer or contract. Intending purchasers should not rely on them as statements of representation of fact, but must satisfy themselves by inspection or otherwise as to their accuracy. No person in this firm's employment has the authority to make or give any representation or warranty in respect of the property.

18 Sutton Plaza, Sutton, Surrey, SM1 4FS

Tel: 020 39 170 160 Email: hello@butlershomes.co.uk butlershomes.co.uk