

Butler's

thoughtful estate agency



Turnpike Lane
Sutton, SM1 4HB
Offers in the region of £280,000



Turnpike Lane, Sutton, SM1 4HB

Few apartments come to market that offer as much as Turnpike Lane. Being such a great layout and size, you'll love sitting in your spacious living room that doesn't just have ample room for you to sit back and relax in, but also has space for you to dine, whether it be with family or friends, grabbing breakfast with the kids before work or even when you throw one of your dinner parties. So, what about the rest of the rooms? Well you'll certainly not be disappointed with the lovely modern kitchen that has more than enough space to cook up a storm in.

When it's time to catch up on some rest, we'll bet that you'll have an amazing nights sleep in your master bedroom that is a sanctuary of style and peace - with you also having lots of space for your wardrobes. The second bedroom is also a fantastic size and one which is perfect for your kids or friends when they stay, and is certainly big enough for you to also set up your home office in, which is invaluable during these times. All the rooms are served by a family bathroom that you can really chill out and relax in after a hard day of zoom calls!

Outside, the landscaped gardens wrap around the building, but the property features another big bonus - a garage - super convenient for parking or storage! Lastly we have to mention the location. Situated close to Sutton, you are only a stones throw from the mainline station, the high street with fabulous shopping & amenities and how can we not mention the schools? If needed, the kids will benefit from some of the finest education in the country!



GROUND FLOOR

Hallway

Living/Dining Room
15' x 11'8 (4.57m x 3.56m)

Kitchen
8'8 x 7'3 (2.64m x 2.21m)

Bedroom
11' x 8'6 (3.35m x 2.59m)

Bedroom
11'9 x 7'1 maximum (3.58m x 2.16m maximum)

Bathroom
8'8 x 3'3 (2.64m x 0.99m)

OUTSIDE

Garage

Communal Grounds

Area Map



Floor Plan

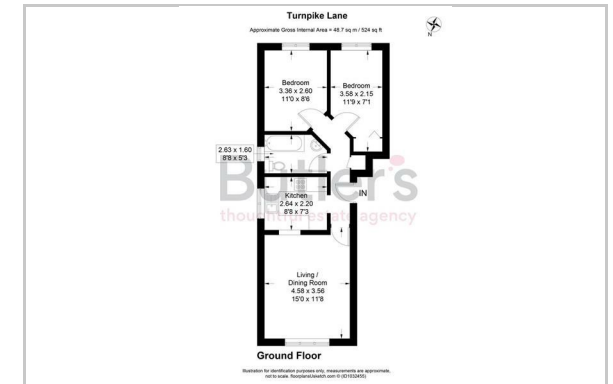

Energy Efficiency Graph

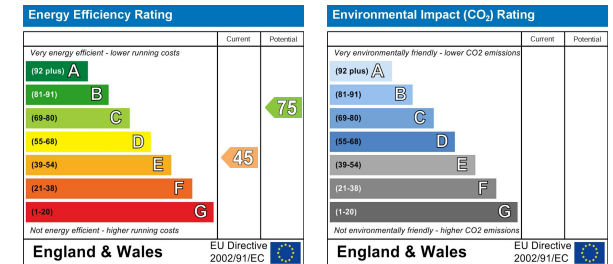

These particulars, whilst believed to be accurate are set out as a general outline only for guidance and do not constitute any part of an offer or contract. Intending purchasers should not rely on them as statements of representation of fact, but must satisfy themselves by inspection or otherwise as to their accuracy. No person in this firm's employment has the authority to make or give any representation or warranty in respect of the property.

18 Sutton Plaza, Sutton, Surrey, SM1 4FS

Tel: 020 39 170 160 Email: hello@butlershomes.co.uk butlershomes.co.uk