



Westside Cherry Green Lane  
Buntingford, Westmill, SG9 9LD

Offers in excess of £1,250,000



# Westside Cherry Green Lane, Buntingford, Westmill, SG9 9LD

\* STUNNING VILLAGE LOCATION JUST 15 MINUTES FROM WARE TOWN- CHAIN FREE - 5 BEDROOM - CIRCA 1.5 ACRE PLOT WITH MULTIPLE OUTBUILDINGS INCLUDING AN ANNEXE - 15M GYM COMPLEX WHICH COULD BE UTILISED AS A 2ND ANNEXE - DESIRABLE AREA \*

Nestled in the desirable village of Westmill in the heart of the stunning Hertfordshire countryside, this exceptional detached property sits on a mature and private 1.5-acre plot with picturesque views. As you approach the property, the grand entrance gates provide an impressive introduction to the luxurious lifestyle that awaits you.

Beyond the gates, the property boasts multiple outbuildings, including a 15m gym complex and detached annexe, providing versatile living space for any modern family. The main house offers 4/5 generously sized bedrooms, multiple reception rooms, a large country style/kitchen diner and has been finished to exacting standards with luxurious touches throughout. From the Sonos surround sound system, CCTV/alarm, air conditioning and full outside lighting, every detail has been carefully considered to ensure maximum comfort and convenience.

Despite its rural location, this property is just a short distance from all local amenities and Ware mainline railway station, which offers direct access to London in just 30 minutes. Whether you're seeking a peaceful retreat or a convenient base for commuting, this property is perfectly situated to meet your needs.



Step Inside

Step Outside

The Guest House

Location

## Area Map



## Floor Plan

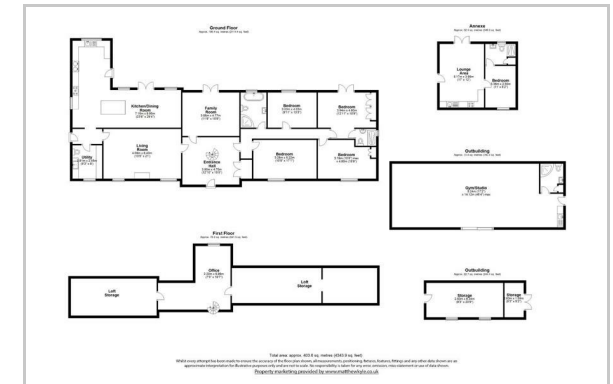

## Energy Efficiency Graph

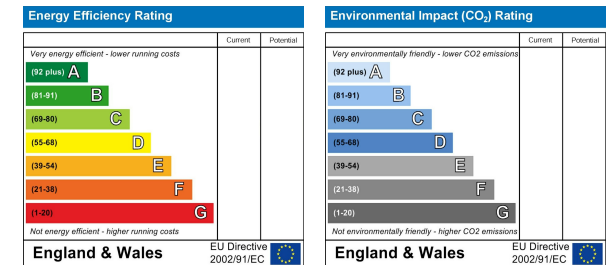

These particulars, whilst believed to be accurate are set out as a general outline only for guidance and do not constitute any part of an offer or contract. Intending purchasers should not rely on them as statements of representation of fact, but must satisfy themselves by inspection or otherwise as to their accuracy. No person in this firm's employment has the authority to make or give any representation or warranty in respect of the property.