



GREENHILL



## The Crescent

Cottered, Buntingford, SG9 9QX

Offers in excess of £500,000



3



2



2



E



# The Crescent, Cottered, Buntingford, SG9 9QX

**\*\*Discover Your Dream Home in Cottered!\*\***

Greenhill Estates is delighted to present this expansive three-bedroom semi-detached house, situated in the picturesque village of Cottered, just a short distance from Buntingford. This property offers not only generous living space but also remarkable potential for further development. With an approved planning application for a rear extension (reference 3/22/0392/HH), you can easily envision expanding your dream home. Additionally, there are further opportunities for reconfiguration or new plans on the side or rear, subject to the necessary consents.

This exceptional property offers a wonderful opportunity to create your ideal home in a sought-after location. Don't miss the chance to experience the lifestyle that Cottered has to offer—contact Greenhill Estates today to arrange a viewing!



## Area Map



## Floor Plan

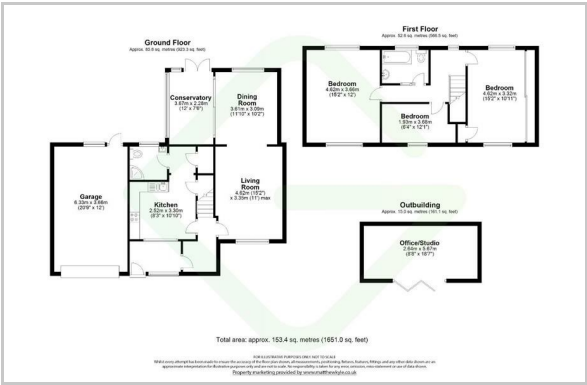

## Energy Efficiency Graph

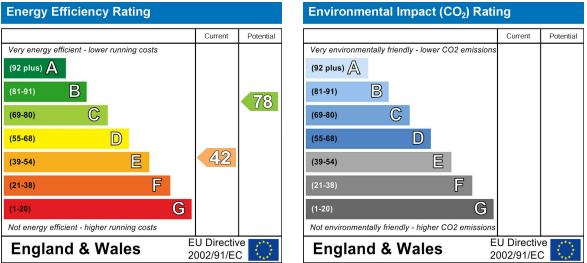

These particulars, whilst believed to be accurate are set out as a general outline only for guidance and do not constitute any part of an offer or contract. Intending purchasers should not rely on them as statements of representation of fact, but must satisfy themselves by inspection or otherwise as to their accuracy. No person in this firm's employment has the authority to make or give any representation or warranty in respect of the property.