



31A The Bury  
, Pavenham, MK43 7PY

Offers in excess of £800,000

5 3 3

A set of four white icons on a dark background: a bed icon with the number 5, a bathtub icon with the number 3, a sofa icon with the number 3, and a three-line menu icon.

# 31A The Bury, Pavenham, MK43 7PY

CHAIN FREE - NEARLY 3000SQ FT - 5 DOUBLE BEDROOMS- 3 BATHROOMS/ 4 TOILETS- MULTIPLE RECEPTION SPACES- SUNNY GARDEN- AMPLE PARKING - HIGH END FINISH

Greenhill Estates are delighted to present to market this exceptional five-bedroom detached family home located in the sought-after village of Pavenham. This home offers a rare opportunity to acquire a newly refurbished luxury property spanning nearly 3000sq ft. Boasting a contemporary design with modern comforts, this residence sets a high standard for family living.

Featuring newly fitted PVCu double glazed windows, oil-fired central heating and solar panels, the house provides both comfort and energy efficiency. The absence of a chain also further enhances its appeal to prospective buyers.

Upon entering, you are greeted by a spacious entrance hall bathed in natural light from floor-to-ceiling windows. The kitchen/diner/family room is a standout feature, showcasing a large island, quartz worktops, modern units, fully integrated high-quality appliances, and bi-fold doors opening to a decking area for seamless indoor-outdoor living. This fantastic space spanning nearly 10 meters in length, is a spacious and social hub ideal for families to gather and connect.



## Location

## Area Map



## Floor Plan

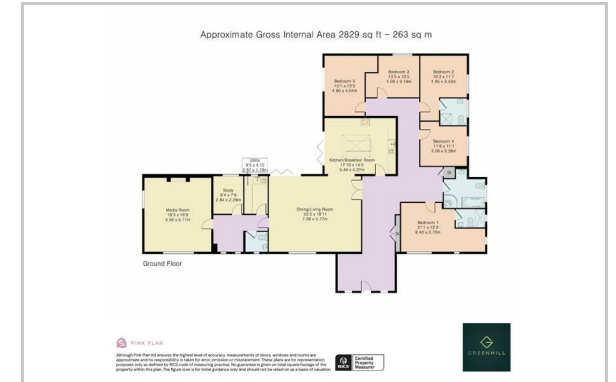

## Energy Efficiency Graph

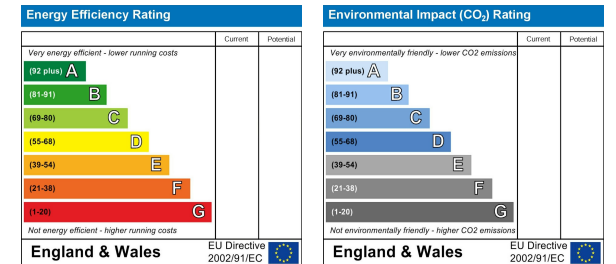

These particulars, whilst believed to be accurate are set out as a general outline only for guidance and do not constitute any part of an offer or contract. Intending purchasers should not rely on them as statements of representation of fact, but must satisfy themselves by inspection or otherwise as to their accuracy. No person in this firm's employment has the authority to make or give any representation or warranty in respect of the property.