



17 Plough Hill  
, Cuffley, EN6 4DN  
Guide price £825,000



# 17 Plough Hill, Cuffley, EN6 4DN

CHAIN FREE- Greenhill Estates is delighted to present Robin House, a modern four bedroom semi-detached property that has been meticulously refurbished to an exceptional standard of contemporary design. The ground floor boasts an open-plan living area, featuring a spacious lounge with bi-fold doors that open onto landscaped gardens and offering off street parking. The German-designed kitchen comes equipped with integrated Neff appliances and elegant stone worktops.

The first floor includes three bedrooms, one of which is en suite, along with a family bathroom. The master bedroom is located on the upper floor and features a walk-in wardrobe and an en suite shower room. Throughout the property, a harmonious color palette and high-quality finishes have been carefully selected, including glass and walnut staircases and walnut internal doors. A block-paved driveway provides convenient parking at the front of the property.

Externally the sunny West facing garden has been meticulously landscaped with a large covered decked area to the immediate rear with the remainder of the garden laid to lawn. The front of the property has been finished with block paving and can accommodate multiple vehicles.



## Location

## Area Map



## Floor Plan

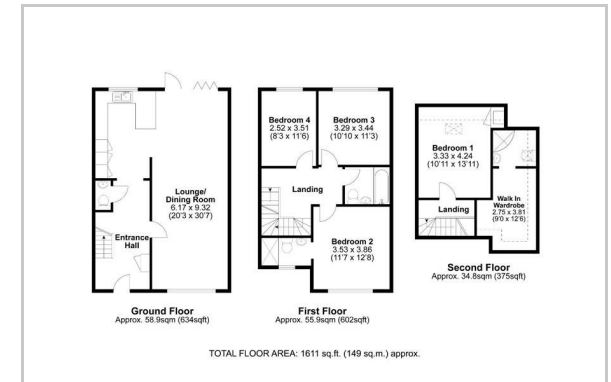

## Energy Efficiency Graph

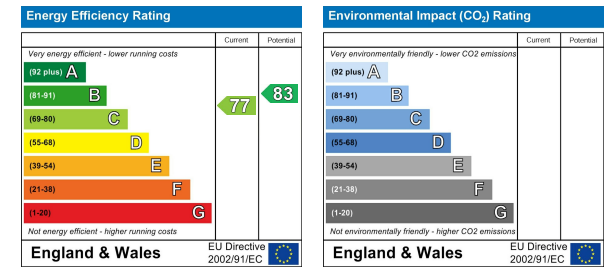

These particulars, whilst believed to be accurate are set out as a general outline only for guidance and do not constitute any part of an offer or contract. Intending purchasers should not rely on them as statements of representation of fact, but must satisfy themselves by inspection or otherwise as to their accuracy. No person in this firm's employment has the authority to make or give any representation or warranty in respect of the property.