

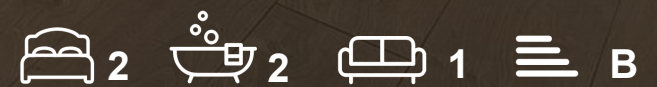

Flat 11 Park Lane  
, Knebworth, SG3 6PJ  
Offers over £425,000



# Flat 11 Park Lane, Knebworth, SG3 6PJ

\*\*\*LAST PLOT REMAINING, ALL OTHER UNITS NOW OCCUPIED\*\*

\*READY FOR OCCUPATION\* Greenhill Estates are delighted to bring to market this truly exceptional NEW BUILD PENTHOUSE 1059sq ft two bedroom, two bathroom apartment with lift access, private covered roof terrace, one allocated parking space and internally has been finished to the highest of standards with gas central heating and high quality fixtures and fittings throughout. Park Lane Court is also conveniently located opposite Knebworth train station which offers direct access into London Kings Cross and Finsbury Park in circa 30 minutes. Knebworth High Street is also a stones throw from the property and offers an array of local ammenties including local shops, pubs and restaurants. Forming part of a bespoke block of brand new apartments, this unique property combines the perfect blend of luxury and convenience and a viewing is strongly advised to appreciate the wonderful home.



Step Inside

Step Outside

Location

Full Specification

## Area Map



## Floor Plan

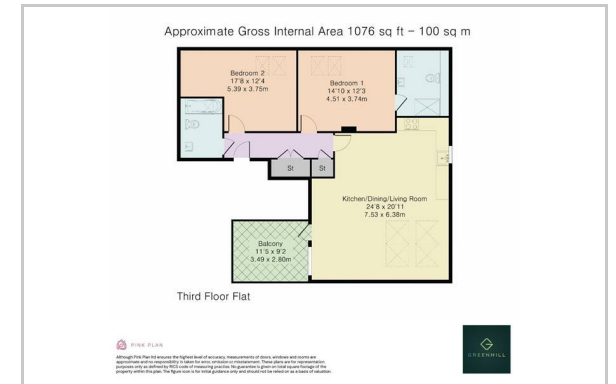

## Energy Efficiency Graph

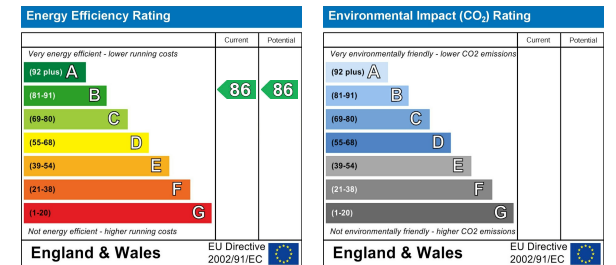

These particulars, whilst believed to be accurate are set out as a general outline only for guidance and do not constitute any part of an offer or contract. Intending purchasers should not rely on them as statements of representation of fact, but must satisfy themselves by inspection or otherwise as to their accuracy. No person in this firms employment has the authority to make or give any representation or warranty in respect of the property.