



Cromwell Road  
Hertford, SG13 7DP  
Asking price £675,000

4 2 2 D

Cromwell Road, Hertford, SG13 7DP

Greenhill Estates are delighted to present this exquisite four-bedroom Semi-Detached period home situated in a highly sought-after residential area. Nestled near fantastic local primary & secondary schools and surrounded by an array of outdoor amenities, such as Hartham Common, The Meads and the local allotments, this property offers an idyllic and convenient lifestyle.



## Area Map

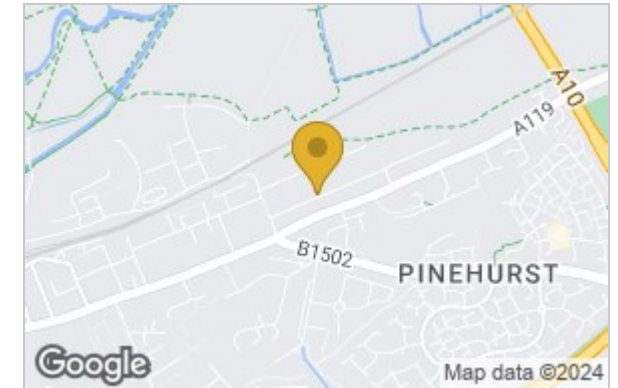

## Floor Plan

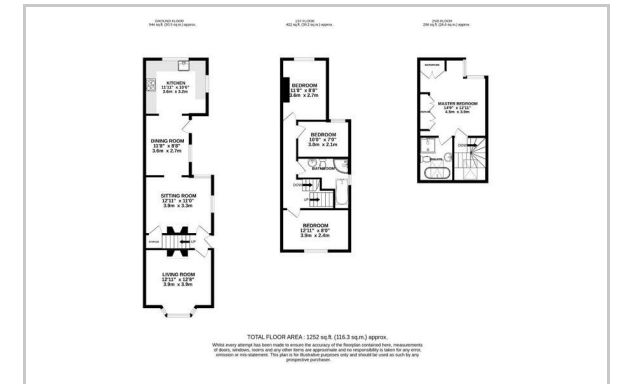

## Energy Efficiency Graph

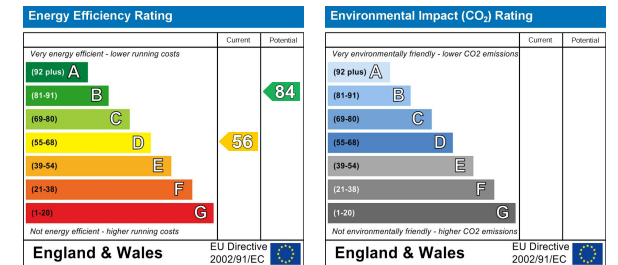

These particulars, whilst believed to be accurate are set out as a general outline only for guidance and do not constitute any part of an offer or contract. Intending purchasers should not rely on them as statements of representation of fact, but must satisfy themselves by inspection or otherwise as to their accuracy. No person in this firm's employment has the authority to make or give any representation or warranty in respect of the property.