



North Cottage Epping Green
, Hertford, SG13 8NB

Offers in excess of £700,000



North Cottage Epping Green, Hertford, SG13 8NB

Greenhill Estates is pleased to present this CHAIN FREE, three bedroom semi-detached home located in the picturesque village of Epping Green, Hertford. This charming property offers abundant potential for customisation and expansion, making it an ideal canvas for creating your dream living space.

Upon entering, you are welcomed by a porch/ entrance hall that opens into spacious reception room that leads to a large conservatory and kitchen/diner, providing a bright and airy space to enjoy throughout the year. Nestled in a tranquil village setting, the residence boasts a spacious 110 ft garden, perfect for outdoor activities and relaxation.

With the opportunity to extend to the rear and potentially convert the garage (subject to the usual consents), you can tailor the home to suit your unique lifestyle and preferences. The property features three comfortable bedrooms, a good-sized bathroom upstairs and an additional downstairs shower room. The property also offers parking for many vehicles, catering to families and those who love to host guests.

Surrounded by local village amenities, including quaint pubs and a village shop, this home offers both convenience and charm. Don't miss out on this fantastic opportunity to own a chain-free home in a sought-after location. Contact us today to arrange a viewing and explore the endless possibilities that await you in this enchanting property.

Area Map



Floor Plan

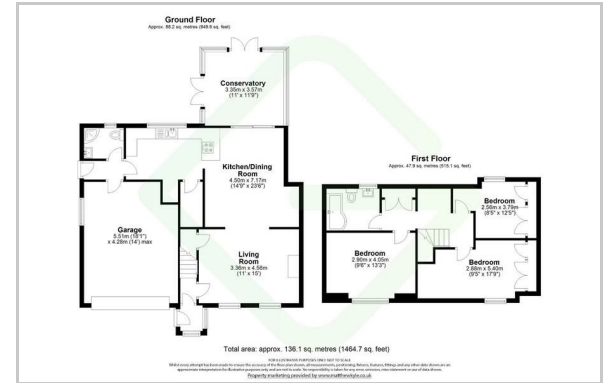

Energy Efficiency Graph

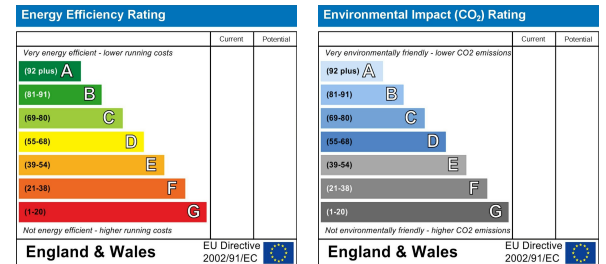

These particulars, whilst believed to be accurate are set out as a general outline only for guidance and do not constitute any part of an offer or contract. Intending purchasers should not rely on them as statements of representation of fact, but must satisfy themselves by inspection or otherwise as to their accuracy. No person in this firm's employment has the authority to make or give any representation or warranty in respect of the property.