

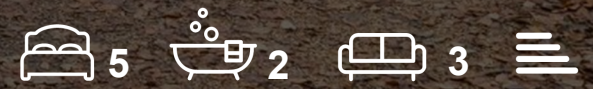

Walnut Tree House only Acorn Street
Hunsdon, Ware, SG12 8PG

Offers in excess of £900,000



Walnut Tree House only Acorn Street, Hunsdon, Ware, SG12 8PG

Greenhill Estates proudly presents Walnut Tree House, a stunning detached Grade II listed property set in the highly sought-after village of Hunsdon on the outskirts of Ware. Set behind private gates, this delightful home boasts over 3000sq ft including five bedrooms, three reception rooms, an impressive kitchen/ diner, two bathrooms, a large carport/garage and beautiful gardens. If you're in search of a splendid rural residence with character and charm, then look no further and arrange an internal tour.



Step Inside

Step Outside

Location



Area Map

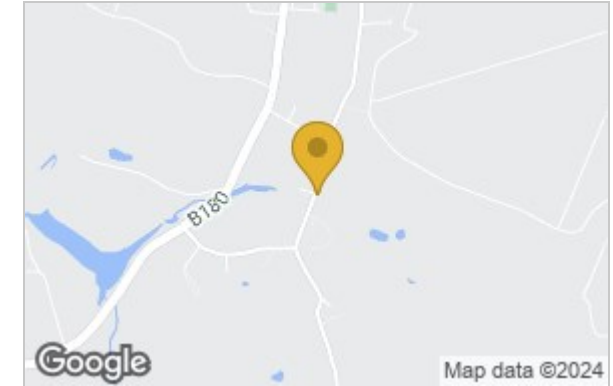

Floor Plan

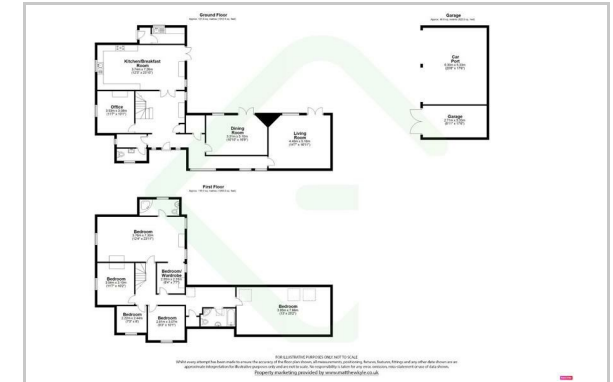

Energy Efficiency Graph

Energy Efficiency Rating		Environmental Impact (CO ₂) Rating	
	Current	Potential	
Very energy efficient - lower running costs			
(92 plus) A			Very environmentally friendly - lower CO ₂ emissions
(81-91) B			(81-91) B
(69-80) C			(69-80) C
(55-68) D			(55-68) D
(39-54) E			(39-54) E
(21-38) F			(21-38) F
(1-20) G			(1-20) G
Not energy efficient - higher running costs			
England & Wales		EU Directive 2002/91/EC	England & Wales

These particulars, whilst believed to be accurate are set out as a general outline only for guidance and do not constitute any part of an offer or contract. Intending purchasers should not rely on them as statements of representation of fact, but must satisfy themselves by inspection or otherwise as to their accuracy. No person in this firm's employment has the authority to make or give any representation or warranty in respect of the property.