



8 Henderson Place
Epping Green, Hertford, SG13 8GA
Offers in excess of £1,500,000

5 3 4 C

8 Henderson Place, Epping Green, Hertford, SG13 8GA

Greenhill Estates is pleased to present for sale this architecturally striking detached eco residence located in an esteemed development nestled in the heart of picturesque countryside, while remaining conveniently close to local amenities. Inside, this remarkable home offers a generous 2700 square feet of luxurious open-plan living space. In recent years, the property has undergone significant remodeling and extension, resulting in an environmentally friendly and technologically advanced living environment that seamlessly connects the indoors with the outdoors through ample glass features. Boasting multiple reception areas, a breathtaking kitchen/dining area, a cozy snug, a practical utility room, a cinema room/fifth bedroom, a guest cloakroom, four spacious double bedrooms, three bathrooms, and a south-facing rear garden with an outdoor kitchen. This home truly stands out from the rest and is best appreciated through a personal viewing.



Step Inside

Step Outside

Location

Specifications



Area Map



Floor Plan

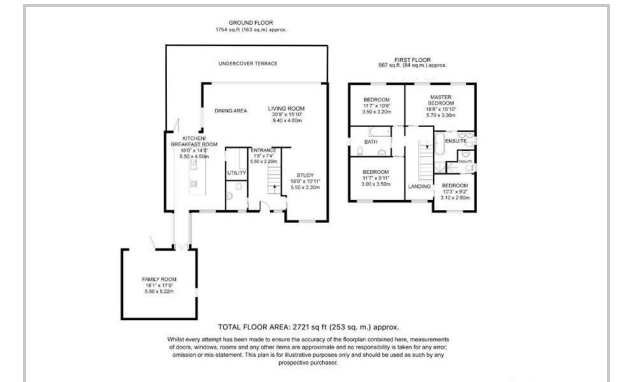

Energy Efficiency Graph

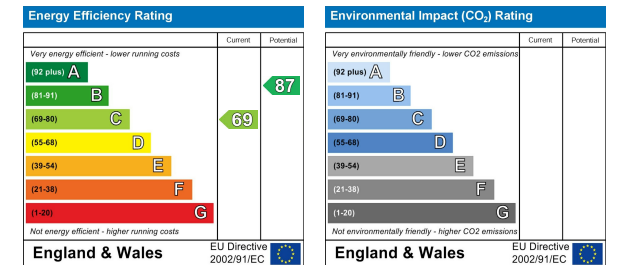

These particulars, whilst believed to be accurate are set out as a general outline only for guidance and do not constitute any part of an offer or contract. Intending purchasers should not rely on them as statements of representation of fact, but must satisfy themselves by inspection or otherwise as to their accuracy. No person in this firm's employment has the authority to make or give any representation or warranty in respect of the property.