



hamlyn
smith.

Sussex Square, Brighton, BN2 1FJ

Guide price
£500,000 - £550,000

hamlyn smith.



2 Bedrooms



1 Reception



1 Bathroom

****Guide price £500,000 - £550,000****

Hamlyn Smith are thrilled to present this stunning two-bedroom penthouse apartment, featuring an expansive 21 sqm roof terrace with breathtaking panoramic sea views. Nestled in the iconic Sussex Square, the property enjoys a prime location in a regency setting.

- Two bedroom apartment
- Panoramic sea views
- Large roof top terrace
- Access to Kemp Town enclosures
- Share of freehold
- No onward chain
- Council Tax band - C





hamlyn smith.

📍 50 Goldstone Villas, Hove, BN3 3RS

☎ 01273 762222

✉ hello@hamlynsmith.co.uk

This exceptional home offers a spacious living space filled with natural light from the West, a sleek modern kitchen fully equipped with integrated appliances including a fridge/freezer and oven, and a contemporary bathroom with a walk-in shower and separate bath. Both bedrooms are generously sized doubles, with one featuring plenty of built-in wardrobes.

Immaculately presented to a high standard, the apartment boasts neutral decor, high ceilings, and large windows that create a bright and airy ambiance throughout. The property is chain-free and ready for immediate occupancy. A standout feature is the impressive roof terrace, accessed via an electronically operated skylight and full staircase, offering a decked and railed space with panoramic views of the sea, Marina, pier, and Sussex Downs.

Additionally, the current owner has architectural designs to enhance the property's value by reconfiguring the layout to include a second bathroom and a semi-open plan kitchen-living area. These plans include architect-drawn designs and structural surveyor calculations (available on request).

Within walking distance of Kemptown village and the Marina, this beautiful apartment has use of 7.5 acres of Grade II listed gardens which have a tunnel to the beach. For the exclusive use of the residents of the Kemptown Estate they are not only private and secure, but also a social focal point of a vibrant and inclusive community.



Ground Floor



First Floor

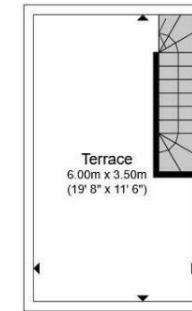

Second Floor



Total floor area 104.5 m² (1,125 sq.ft.) approx

This floor plan is for illustrative purposes only. It is not drawn to scale. Any measurements, floor areas (including any total floor area), openings and orientation are approximate. No details are guaranteed, they cannot be relied upon for any purpose and they do not form part of any agreement. No liability is taken for any error, omission or misstatement. A party must rely upon its own inspection(s). Powered by www.focalagent.com

