



 **3**
Bedrooms

 **2**
Bathrooms



Located on this highly popular road near Ealing Road is this extended three-bedroom, two-bathroom family home. Internally the property is presented in very good condition with a 6m kitchen/dining room, separate family lounge and two shower rooms all located on the ground floor. To the first floor you will find all three bedrooms and access to a partially converted loft. Externally to the front there is off street parking whilst to the rear a large family garden. All in all, this is one not to be missed.

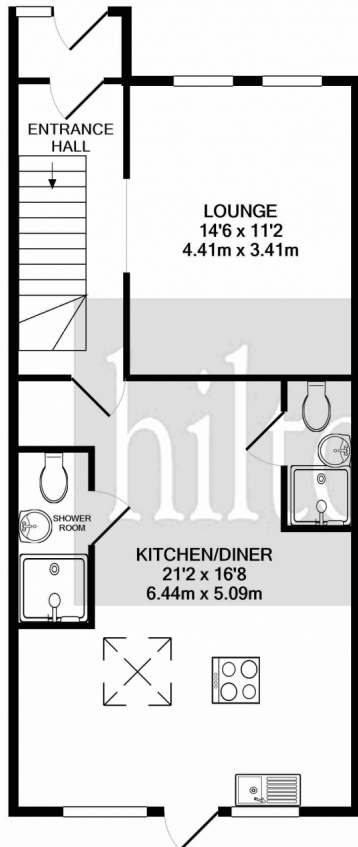

GROUND FLOOR
APPROX. FLOOR
AREA 613 SQ.FT.
(57.0 SQ.M.)

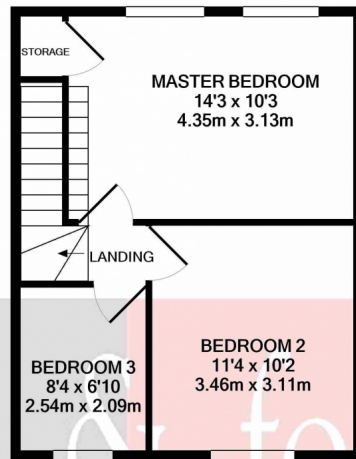

1ST FLOOR
APPROX. FLOOR
AREA 361 SQ.FT.
(33.5 SQ.M.)
TOTAL APPROX. FLOOR AREA 974 SQ.FT. (90.5 SQ.M.)

Whilst every attempt has been made to ensure the accuracy of the floor plan contained here, measurements of doors, windows, rooms and any other items are approximate and no responsibility is taken for any error, omission, or mis-statement. This plan is for illustrative purposes only and should be used as such by any prospective purchaser. The services, systems and appliances shown have not been tested and no guarantee as to their operability or efficiency can be given.
Made with Metropix ©2022

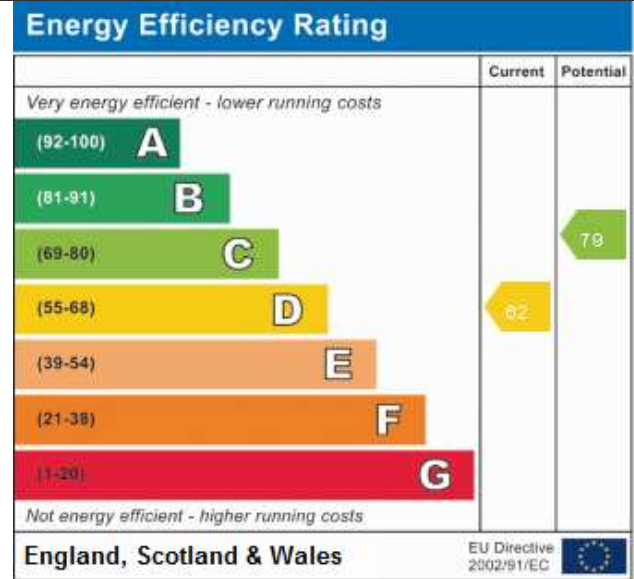



Wembley Central

Talbot Rd

Ranelagh Rd

Lonsdale Ave
Cecil Ave

Clifton Ave
Jesmond Ave

Berkhamsted Ave

St. Michaels Ave
Vivian Ave
Georgian Ct

Tudor Ct

Cha Sha Wembley



Lincoln Rd

Station Grove
Park Rd

Middlesex Manor
Care Home - Bupa



Norton Rd

Lyon Park Ave

Tokington Ave

Victoria Ave

Thurby Rd

The Cl

Douglas Ave

Argenta Way

Wigginton Ave

Sakonis



Westbury Rd

Hillfield Ave



Bowrons Ave

Clayton Ave

Dorothy Ave

Egerton Rd

Lyon Park Ave

Argenta Way



Shri Vallabh Nidhi
Mandir - Hindu...

Woodstock Rd

Heather Park Dr



Alperton
Community School

Stanley Park Dr

Mount Pleasant

Kenmere Gardens

A4005

Alperton



London Shootfighters

Woodside Cl

Belmont Ave

Beresford Ave

Ace Cafe London



Brent