



3

Bedrooms



1

Bathroom





This semi-detached house in Park Royal offers a practical living space with three bedrooms, one bathroom, and two reception rooms. The property features a functional kitchen and a garden, providing a comfortable setting for everyday living. Situated in a convenient location, it provides easy access to local amenities and transport links.

GROUND FLOOR  
429 sq.ft. (39.9 sq.m.) approx.

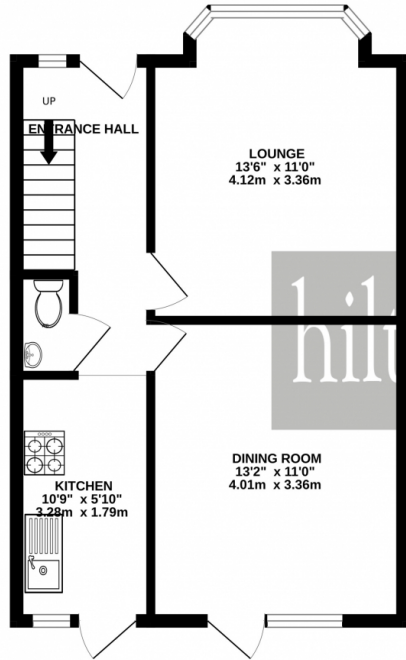

1ST FLOOR  
379 sq.ft. (35.2 sq.m.) approx.

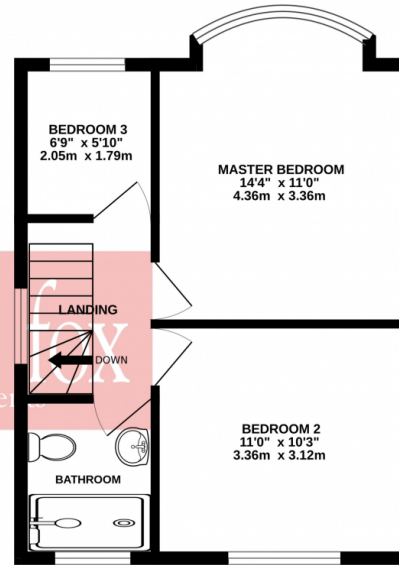

TOTAL FLOOR AREA : 808 sq.ft. (75.1 sq.m.) approx.

Whilst every attempt has been made to ensure the accuracy of the floorplan contained here, measurements of doors, windows, rooms and any other items are approximate and no responsibility is taken for any error, omission or mis-statement. This plan is for illustrative purposes only and should be used as such by any prospective purchaser. The services, systems and appliances shown have not been tested and no guarantee as to their operability or efficiency can be given.

Made with Metropix ©2025



