



3

Bedrooms



1

Bathroom



Located on this Highly Popular Road in Alperton is this Three Bedroom, Two Reception Family home. Internally to the ground floor you will find a lounge, dining room and family kitchen. Whilst to the first floor there are all three bedrooms and the family bathroom. Externally to the front there is off street parking for a number of cars and to the rear a private North/East facing family garden. As this is just a short distance from the popular Ealing Road early viewing is highly advised.

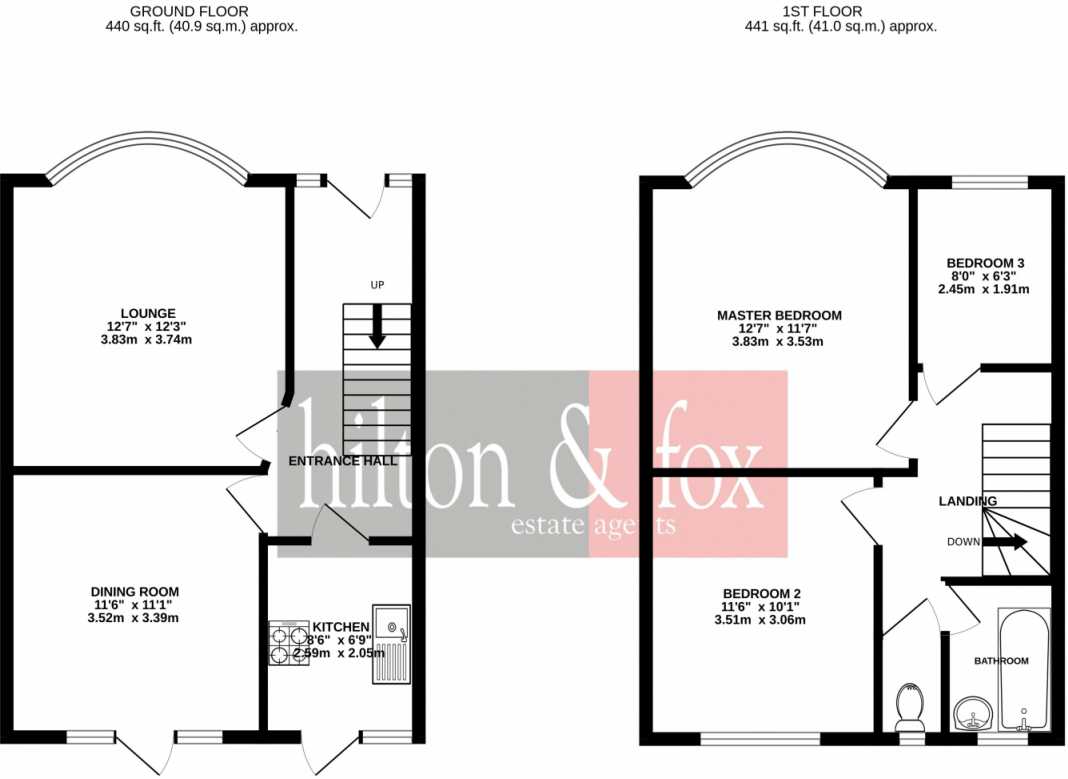

TOTAL FLOOR AREA : 881 sq.ft. (81.9 sq.m.) approx.

Whilst every attempt has been made to ensure the accuracy of the floorplan contained here, measurements of doors, windows, rooms and any other items are approximate and no responsibility is taken for any error, omission or mis-statement. This plan is for illustrative purposes only and should be used as such by any prospective purchaser. The services, systems and appliances shown have not been tested and no guarantee as to their operability or efficiency can be given.

Made with Metropix ©2025

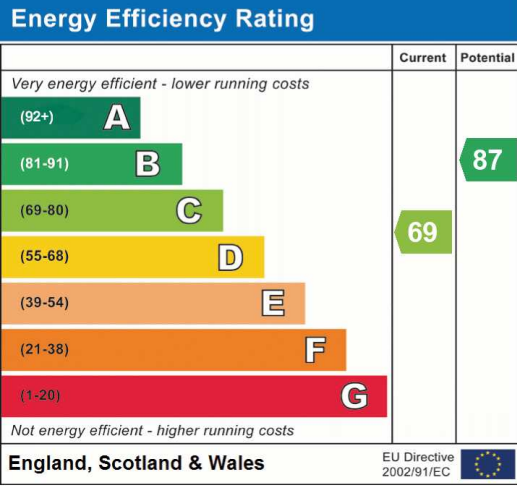

Address: Woodside Avenue, Wembley, Middlesex HA0





TRADER Wembley

Sakonis

Stanley Corner Medical Centre

Alpertons Cemetery

Shri Sanatan Hindu Mandir

Amols Vada Pav

Alpertons Community School (Upper Site)

Apply4U

NorthFeilds Industrial Estate

The One Hundred

Alpertons

Paddington Branch

Markaz Us-Sunnah

Sainsbury's

Sainsbury's Petrol Station

Travelodge

Hoo Hing - Park Royal

FCI London