 **2**  
Bedrooms

 **1**  
Bathroom

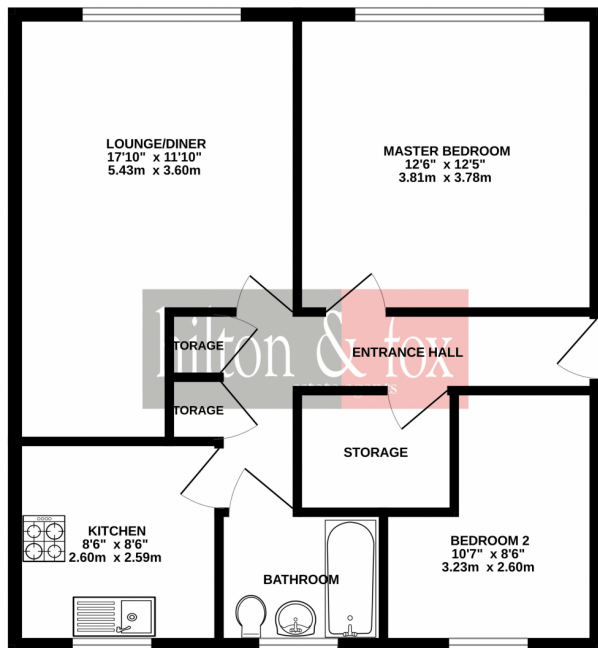

Offered with no further chain and in good condition throughout is this Two Bedroom First Floor Flat. Internally you will find a large lounge/diner, Two Double Bedrooms, Family bathroom, family kitchen and ample storage. Externally you will find that the property is ideally placed giving you easy access to Harrow High Street and its variety of shops and transport links. All in all, one not to be missed.

GROUND FLOOR  
639 sq.ft. (59.4 sq.m.) approx.



TOTAL FLOOR AREA : 639 sq.ft. (59.4 sq.m.) approx.

Whilst every attempt has been made to ensure the accuracy of the floorplan contained here, measurements of doors, windows, rooms and any other items are approximate and no responsibility is taken for any error, omission or mis-statement. This plan is for illustrative purposes only and should be used as such by any prospective purchaser. The services, systems and appliances shown have not been tested and no guarantee as to their operability or efficiency can be given.  
Made with Metropac ©2012

Energy Efficiency Rating		
	Current	Potential
Very energy efficient - lower running costs		
(92+) <b>A</b>		
(81-91) <b>B</b>		<b>84</b>
(69-80) <b>C</b>	<b>76</b>	
(55-68) <b>D</b>		
(39-54) <b>E</b>		
(21-38) <b>F</b>		
(1-20) <b>G</b>		
Not energy efficient - higher running costs		
England, Scotland & Wales		EU Directive 2002/91/EC 

Address: Hawkins Close, Harrow, Middlesex HA1





Harrow Bus Garage

A404

Harrow Cemetery

Harrow Recreation Ground

Tunnel | Lounge

Hindes Rd

Headstone Rd

Wellesley Rd

Weldon Cr

Vaughan Primary School

Morrisons

St George's Shopping Centre

Harrow Wall Climbing Centre

Harrow

West Harrow

McDonald's

Vaughan Rd

Vaughan Rd

Harrow-on-the-Hill (HOH)

Butler Rd

Butler Ave

A312

West Harrow Recreation Ground

Our Lady & St Thomas of Canterbury Church

Harrow College

The Grove Open Space

GP Direct

Indian Gastro Kitchen @ Kingsfield Arms

Whitmore Rd

Churchfields

Grove Hill

Peterborough Rd

Whitmore High School

Whitmore Rd

Tintern Way

McDonald's

Porlock Ave

Merton

Harrow School

The Castle Harrow