



 **3**

Bedrooms

 **1**

Bathroom



Located on the Highly Popular Sudbury Court Estate is this Three Bedroom, Three Reception semi-detached family home. Internally the property could benefit from some updating but offers a large living area with a lounge, dining room, breakfast room and kitchen on the ground floor. On the first floor you will find all three bedrooms, the family bathroom and separate WC. Externally there is off street parking to the front leading to your own garage and to the rear there is a good size well established family garden. All in all, one not to be missed.

GROUND FLOOR
617 sq.ft. (57.3 sq.m.) approx.

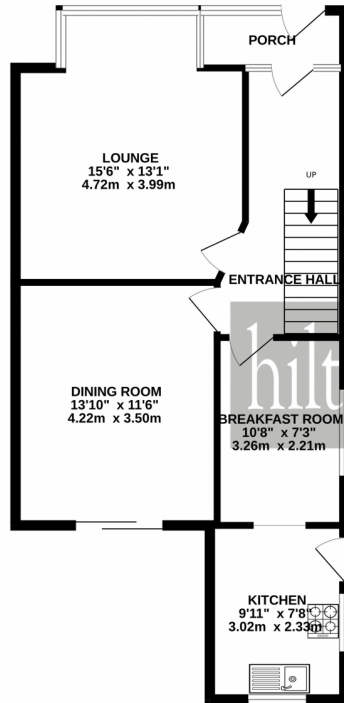

1ST FLOOR
514 sq.ft. (47.8 sq.m.) approx.

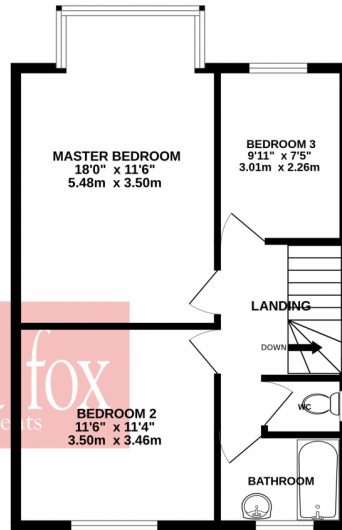

TOTAL FLOOR AREA: 1131 sq.ft. (105.1 sq.m.) approx.

Whilst every attempt has been made to ensure the accuracy of the floorplan contained here, measurements of floors, windows, rooms and any other items are approximate and no responsibility is taken for any error, omission or mis-statement. This plan is for illustrative purposes only and should be used as such by any prospective purchaser. The services, systems and land appliances shown have not been tested and no guarantee as to their operability or efficiency can be given.
Made with Metropix ©2024





Harrow MS Therapy Centre

The Windermere

Preston Park

South Kenton

SF Mini Chefs

Rupal Tailoring

Mumbai Junction Restaurant Wembley |...

Blue Court Dental Centre

Sihara Care

Wembley High Technology College

Tarsin Londra/Wembley

JR Alloy Wheel Repair

SIXT Car & Van Hire - London Wembley

East Lane Business Park

North Wembley

Aroma Lounge

NORTH WEMBLEY

44088

Vale Farm Sports Centre