



Fair Green
Reach, CB25 0JD
Guide Price £350,000

Fair Green, Reach, CB25 0JD

A charming home nestling within the heart of this sought after village and enjoying a lovely view to the front overlooking the local green.

Hugely improved and cleverly extended, the property has been updated in recent years and offers a fabulous open plan kitchen/living room/family room with built fold doors to the rear, cloakroom, two bedrooms and a first floor bathroom.

Externally the property offers a delightful fully enclosed rear garden with patio area.

NO CHAIN – VIEWING HIGHLY RECOMMENDED.

EPC G

Council Tax C (East Cambs)

Accommodation Details:

Fully glazed front entrance door through to the:

Kitchen 15'10" x 14'9" (4.83 x 4.50)

Fitted with a range of matching eye and base level storage units and working tops over, inset sink and drainer with mixer tap and breakfast bar with pendant lighting over. Integrated appliances including oven and four-ring electric hob, dishwasher and fridge/freezer. Staircase rising to the first floor with storage cupboard under, with space and plumbing for a washing machine, and window to the front aspect.

Living/Family Room 24'7" x 14'9" (7.50 x 4.50)

Spacious living room with

modern wood burner, laid hard wood flooring, TV connection point, two large bespoke cabinetry cupboards and shelves with retractable desk, two skylights and bi-folding doors out to the rear garden.

WC 6'2" x 4'1" (1.90 x 1.27)

With low level WC and wash basin.

First Floor Landing

With doors leading through to the bedrooms and bathroom.

Bedroom 1 13'1" x 12'0" (3.99m x 3.66m)

Double bedroom with eaves storage, laid wooden flooring, radiator, skylight and window to the rear aspect.

Bedroom 2 12'5" x 8'6" (3.80 x 2.60)

With built in wardrobes, laid wooden flooring, radiator and window to the front aspect.

Bathroom

Three piece suite comprising of a low level WC, pedestal wash basin, P-shaped bath with wall mounted shower, part tiled walls and skylight.

Outside - Rear

Fully enclosed rear garden with paved patio area with timber storage units. Laid to lawn area with a variety of mature trees and shrubs, rear pedestrian gate.

Outside - Front

Enclosed by dwarf bricked wall.



GROUND FLOOR

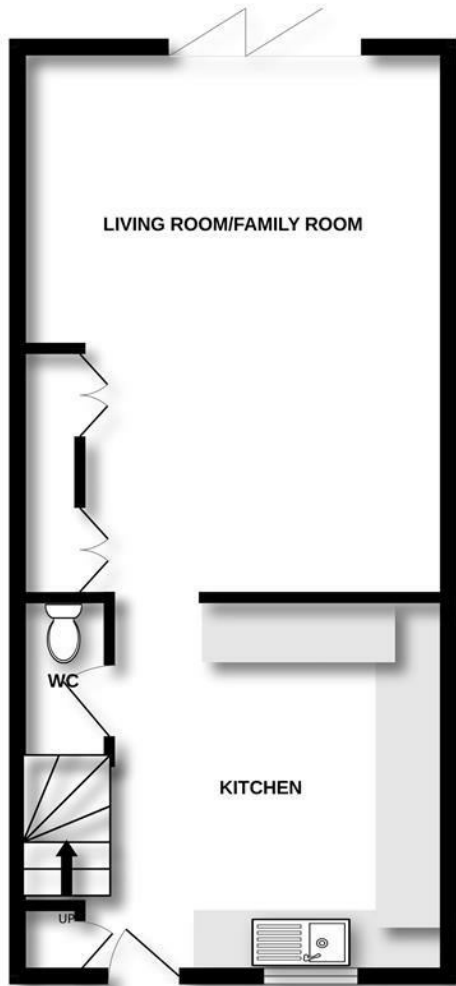

1ST FLOOR

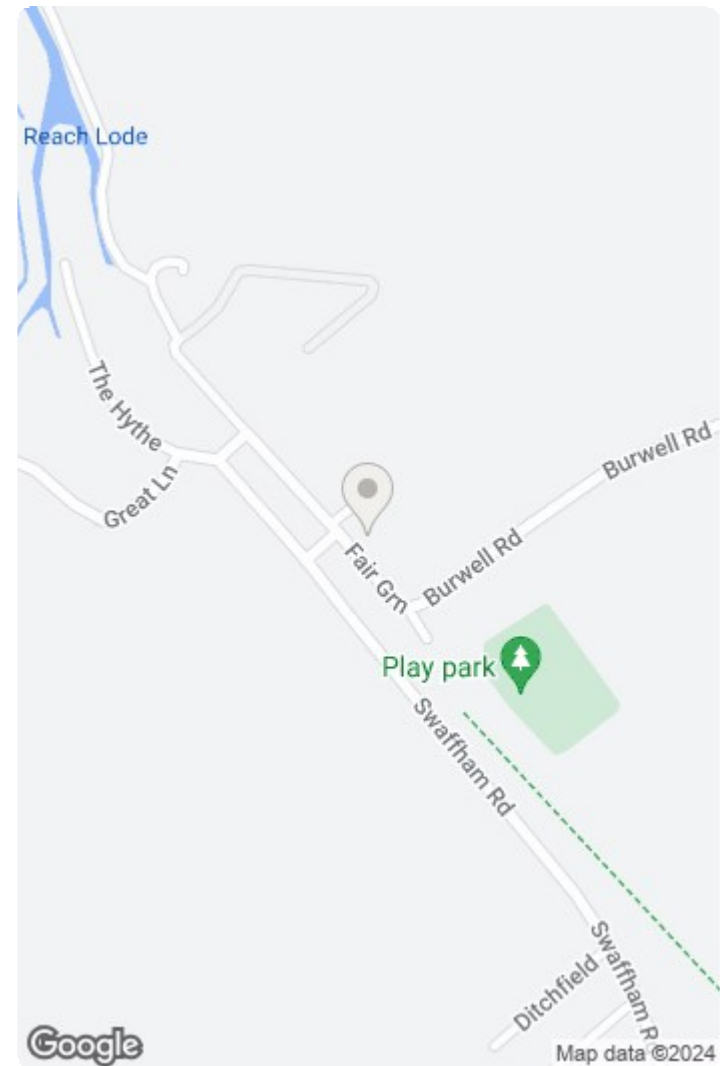
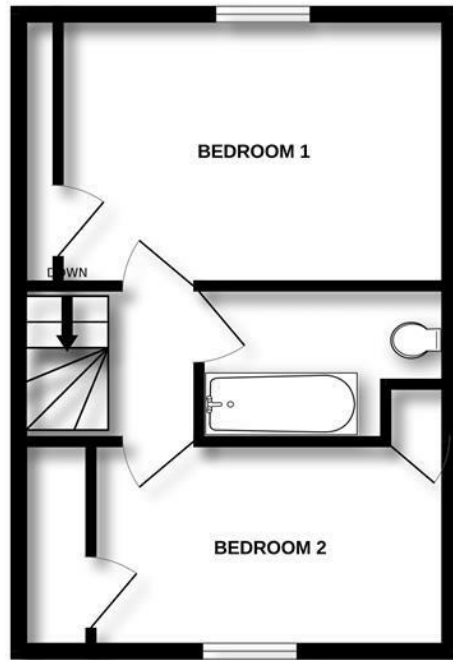

Whilst every attempt has been made to ensure the accuracy of the floorplan contained here, measurements of doors, windows, rooms and any other items are approximate and no responsibility is taken for any error, omission or mis-statement. This plan is for illustrative purposes only and should be used as such by any prospective purchaser. The services, systems and appliances shown have not been tested and no guarantee as to their operability or efficiency can be given.
Made with Metropix ©2024

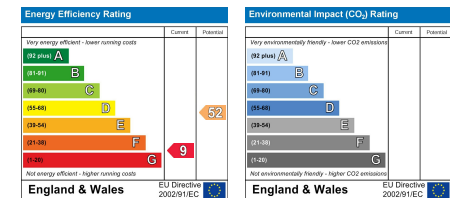

This document and any marketing relating to the property has been prepared in good faith to give a fair overall view of the property and must not be relied upon as statements or representations of fact. It is suggested that undertake enquiries by inspections, survey or other investigation to ascertain the viability of any purchase. Any areas, measurements or distances referred to are given as a guide only and are not precise and no liability can be accepted for errors arising them therefrom. Photographs are not necessarily comprehensive nor current; no assumption should be made that any contents shown are included in the sale. Morris Armitage have not tested any services or equipment and nothing in these particulars should be deemed to be a statement that they are in good working order nor that the property is in good structural condition.





