

TO LET

Nassau Street, Fitzrovia
£681 pw + security deposit

Living Space are pleased to offer this three double bedroom three bathroom apartment located within close proximity of

- Conversion
- 3 Beds
- 1 Reception
- 3 Bathrooms
- Furnished or Unfurnished
- Gas Central Heating



**£681 pw +
security deposit**

**Nassau Street,
Fitzrovia,**

W1W 7AG

Living Space are pleased to offer this three double bedroom three bathroom apartment located within close proximity of several tube stations and the fantastic amenities of Fitzrovia and Marylebone. The property is located minutes from Goodge Street and Oxford circus tube stations and close to all amenities. Must be seen. Available on the 13th August 2021.



>> Key Features

- Conversion
- 3 Beds
- 1 Reception
- 3 Bathrooms
- Furnished or Unfurnished
- Gas Central Heating

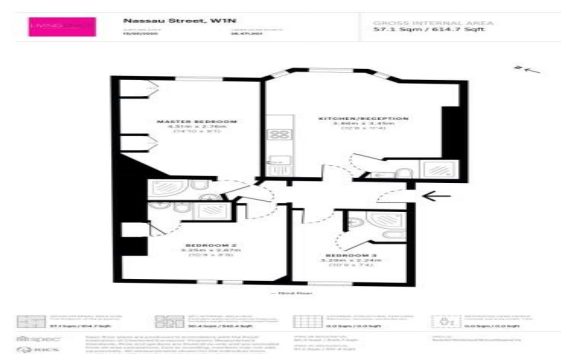



Directions

Energy Efficiency Rating			Environmental Impact (CO ₂) Rating		
	Current	Potential		Current	Potential
Very energy efficient - lower running costs			Very environmentally friendly - lower CO ₂ emissions		
(92-100) A			(92-100) A		
(81-91) B		82	(81-91) B		86
(69-80) C	75		(69-80) C	76	
(55-68) D			(55-68) D		
(39-54) E			(39-54) E		
(21-38) F			(21-38) F		
(1-20) G			(1-20) G		
Not energy efficient - higher running costs			Not environmentally friendly - higher CO ₂ emissions		
England	EU Directive 2002/91/EC		England	EU Directive 2002/91/EC	

Our Fees

Relevant letting fees and tenant protection information for Assured Hold Tenancy & Licences

signing from the 1st of June 2019

As well as paying the rent, you may also be required to make the following permitted payments.

Permitted payments

...